



register and win!
www.karcher.com

 **KÄRCHER®**

RC 3000



中文	2
English	16



5.962-905.0 (05/08)

目录

操作功能与模式	2
安全指南	3
要点参考	4
操作控制	5
操作前准备	6
拆包装	6
泊位充电器安装条款	6
操作	7
清洁前准备工作	7
首次操作	7
关闭智能机器人	7
停机	8
选择清洁时间	8
静噪模式	8
操作程序	8
技巧与提示	9
维护与保养	9
泊位充电器	9
智能机器人	10
故障排除	12
技术数据	13
零部件表	13
常见问题	14

注意:

在未仔细阅读操作指南之前，请不要使用设备。
请妥善保存说明书，以供自己日后使用或新机主使用。

操作功能与模式

亲爱的消费者

非常感谢您购买凯驰的RC3000清洁设备。

RC3000是专门针对消费者用于室内清洁的全自动清洁设备。可用于所有通用地面的自动持续清洗。这台设备包括两部分：泊位充电器；智能机器人

智能机器人由可充电电池操作的。它随机移动，若遇到障碍，它会随机选择一个的角度，改变方向。然后，按照直线继续前进，直到遇到新的障碍。扁平的设计，保证了设备可以在家具的下方进行清洁，例如，可清洁床、沙发、茶几、衣橱等等家具下面。在设备上还安装了光敏元件，防止其从楼梯上掉下。

该设备提供了四种操作程序，使其在清洁时根据地面的污渍程度可自动调节。操作程序控制系统由污渍传感器收集到的污渍积累程度决定。

若电池充满电，该设备可不间断工作60分钟。在前20分钟使用后，智能机器人（红外接收器）开始自动搜索泊位充电器（红外发送器），若60分钟后，仍未搜索到泊位充电器，他就会停止清洁工作，集中寻找泊位充电器，该过程将持续60分钟左右。

泊位充电器能为智能机器人提供充电服务，并将智能机器人收集的垃圾排空至过滤纸袋。一旦充电过程完成，智能机器人将再次离开泊位充电器，继续清洁工作。

适用范围

RC3000适用于清洁个人房间内的地毯类织物以及硬地板表面

请不要将RC3000使用于

- 湿地板
- 淋浴房以及其他的湿房间
- 楼梯
- 桌面以及柜子顶部
- 地下室与阁楼
- 仓库以及工业建筑
- 室外
- 沸腾的和燃烧的物体（如香烟，热灰）

以下地点，请不要使用RC3000

- 具有潜在爆炸性的地点
- 空气中含有易燃的苯，汽油，图画稀释剂，溶剂，煤油等化学品的房间
- 在房间内有无人管理的明火
- 在房间内有无人管理的电炉
- 内装有报警装置，或是运动监视器的房间

安全指南

- 凯驰电器产品达到了机械产品与设备条例的要求（EC Directive 73/23/EEC）。
- 主供电压必须稳定。
- 在使用之前，检查电线状况。如果电线有任何损坏，请不要使用。
- 在拔出插头时，请拔插头，而不要拔电线。
- 请不要用湿手碰插头（小心电击）。
- 在任何维护工作之前，请将电线拔掉。
- 电线只能在凯驰特许的服务中心更换原装电线。
- 只在特许的服务中心进行维修。
- 只使用经生产厂商认可的零部件和附件。使用原装零部件保证了使用的安全与无误。
- 当RC3000在房间内进行清洁工作时，请不要将无人照顾的儿童留在房间内。
- 儿童与未经指导的人员不得操作。
- 儿童必须被告知并确保在设备工作时不能玩耍设备。
- 当设备在工作时请注意（小心摔跤）。
- 请不要站或坐在智能机器人或泊位充电器上。
- 如果智能机器人撞在某些物体上，可能会将物体撞倒。（包括一些在桌上的物体，或是一些小家具）
- 智能机器人可能会在电话线，电线，桌布，窗帘，带子之间迷失方向，最严重的情况，可能将连在这些线路上的设备从上面拉下来。
- 如果将设备用于与其目的不同的用途上，造成的损坏，由消费者自己承担。
- 泊位充电器上的充电设备只能用于智能机器人充电。
- 智能机器人的电池，只能在泊位充电器上进行充电。

要点参考

1. 安装 RC300

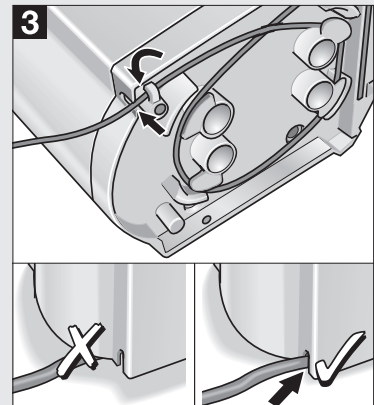
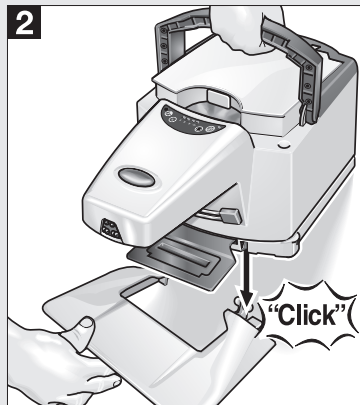
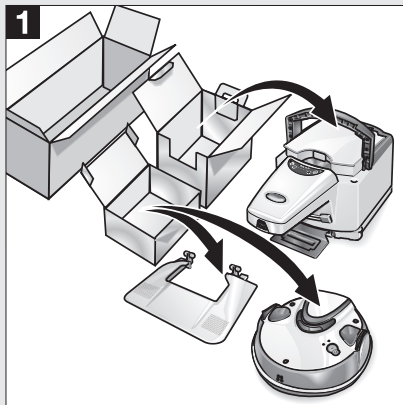

2. 启动 RC3000

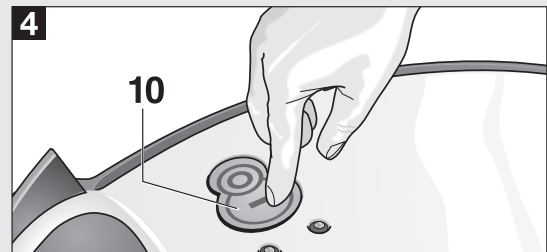
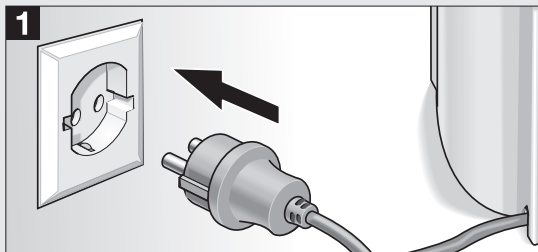

3. 指示灯 (12)

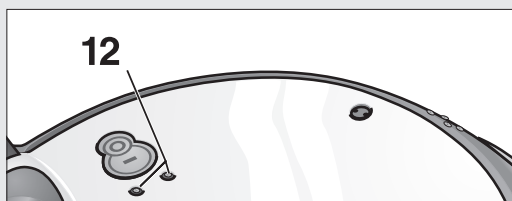

绿色	持久亮灯	清洁操作
	慢速闪动 (亮一秒, 灭4秒)	智能机器人搜索泊位充电器
	快速闪动 (亮半秒, 灭半秒)	电池需要充电
红色	详见13页, 故障排除	

操作控制

泊位充电器排空移动充电器

- 1、可提式手柄（用于泊位充电器的转移）
- 2、内凹按钮（用于打开过滤器外盖）
- 3、操作仪表板
- 4、开/关
- 5、红外发送器
- 6、吸尘孔
- 7、智能机器人进入斜坡道（机器人可泊入泊位充电器）
- 8、电池连接触点
- 9、电源线

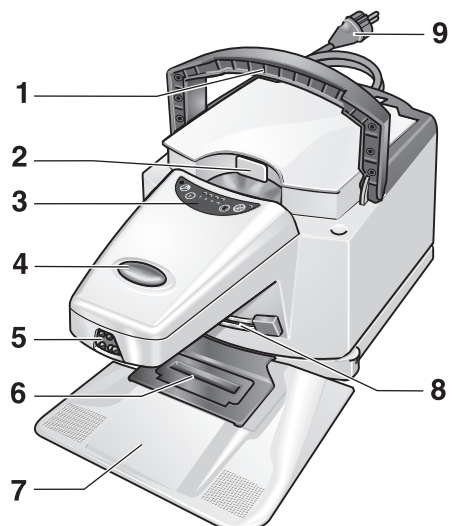

操作仪表板（3）

- A. 指示灯（绿色）-智能机器人停放
- B. 停放智能机器人 按钮 开或关
- C. 清洁时间设置 按钮
- D. 指示灯（绿色）-3 小时清洁
- E. 指示灯（绿色）-6 小时清洁
- F. 指示灯（绿色）-9 小时清洁
- G. 指示灯（绿色）-持续清洁
- H. 指示灯（红色）-过滤纸袋已满
- I. 静噪模式 按钮-开或关
- J. 指示灯（绿色）-静噪模式

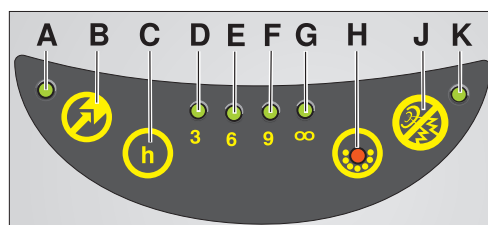

智能机器人清洁

- 10、启动 按钮
- 11、关闭 按钮
- 12、LEDs（绿色-操作/红色-故障）
- 13、电池连接触点
- 14、安全缓冲器
- 15、红外接收器
- 16、滚刷
- 17、光敏元件（4X）
- 18、电池（2X）
- 19、污物箱上锁扣（2X）
- 20、污物箱外盖
- 21、污物箱

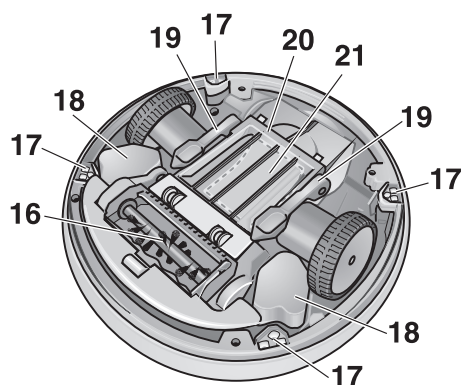
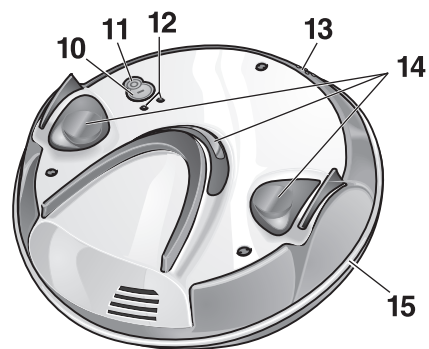

准备工作

拆开外包装

当您在拆外包装时，请检查包装箱内的所有部件是否完整，若丢失某种零件或由于运输造成了产品的损坏，请立即与您的经销商联系。

请将外包装材料合理处置。

外包装材料均为可回收材料。请不要将它随便丢弃，而是将它送到相关回收站进行回收再利用。

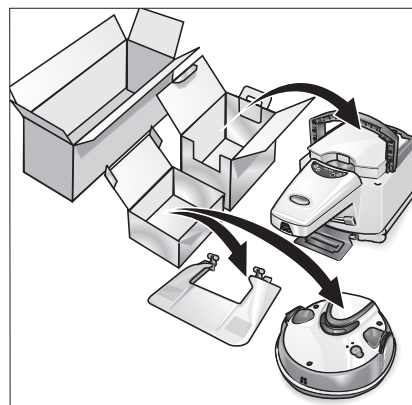

Figure 1

安装导入斜坡道

将进入斜坡道倾斜的握住

将斜坡道的钉口插入泊位充电器槽口内，固定

将斜坡道下按，直到锁紧

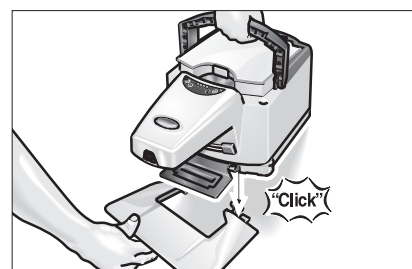

Figure 2

泊位充电器的安装条款

当您把泊位充电器固定在某一个位置的时候，请确保智能机器人能够轻易的往返于清洁区域与泊位充电器之间

(见图 4a 与 4b)

- 将泊位充电器安置在一个平坦的地方
- 不要在泊位充电器前方，放置任何物品
- 不要在泊位充电器前方放置电线，(防止智能机器人回返时受阻)
- 拉出电线时，拉到所需的长度为止
- 确保电线被拉出时，是通过电线的槽口。(图 3)
- 将主电线插在墙上插座

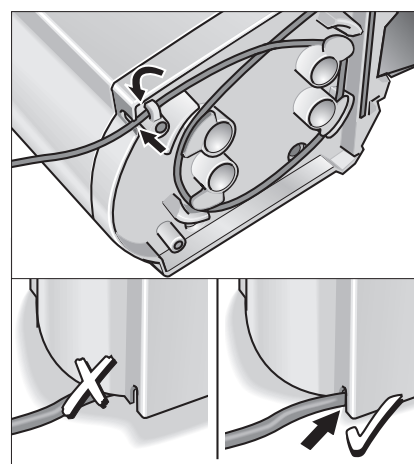

Figure 3

清洁一个房间

(图 4a) 将泊位充电器置放在需要清洁的房间，该设备可通过调解选择工作时间长度来配合清洁房间的大小。(见 9 “选择清洁时间”)

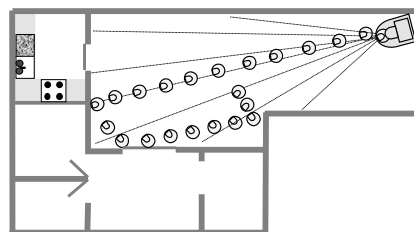

Figure 4a

清洁所有地面

将泊位充电器放置在一个房间内，智能机器人将清洁所有房间 (图 4b)

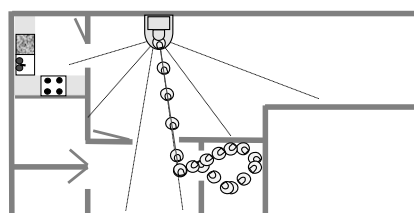

Figure 4b

操作

清洁准备工作

请确保当智能机器人在工作时，地板上没有障碍物。

例如：可能的障碍物包括： — 报纸，书本，杂志，纸张 — 服装，玩具，CDs盘片 — 塑料袋 — 瓶子，玻璃 — 落地窗帘 — 卧房中的睡席	例如，以下物品不算作障碍物 — 房间中的单根电线 — 不足1cm 高的门槛 — 低于10cm 的地毯边缘
--	---

初次使用

- 启动泊位充电器（开关 4）（持续清洁指示灯 G 将闪亮）
- 将智能机器人放置在泊位充电器前方
- 启动智能机器人（按钮 10）（智能机器人第一次回到泊位充电器是为了清空污物箱，并且检查电池状况，如果需要，将进行电池充电，然后，智能机器人会进行清洁工作。）

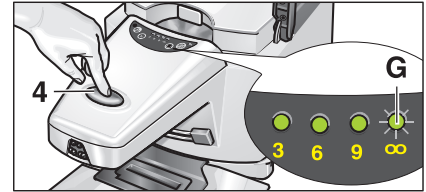

Figure 5

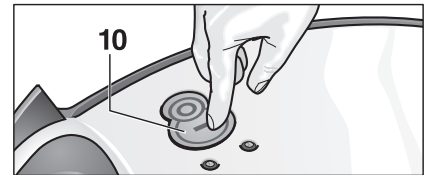

Figure 6

指示灯（12）

绿色	持续使用指示灯很慢的闪动（亮一秒，暗 4 秒） 持续使用指示灯很快的闪动（亮半秒，暗半秒）	智能机器人搜索泊位充电器，需要充电。
红色	详见 13 障排除	

在长期贮藏之后，使用清洁器的具体操作

若智能机器人内无电量，智能机器人无法启动。请按以下操作步骤进行操作。

- 将智能机器人放在泊位充电器旁边，将智能机器人的电池接点与泊位充电器的充电接点按在一起大约持续60秒（图7）

在此期间，污物箱是空的

- 将智能机器人置于离泊位充电器50厘米的地方，启动智能机器人。按钮10

智能机器人将会自动回到泊位充电器中，进行充电，大约持续60分钟左右。

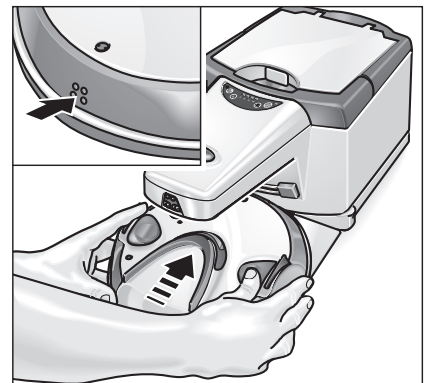

Figure 7

关闭智能机器人

如果您希望智能机器人立即停止清洁工作，或者需要，智能机器人清洁其他区域，然后

- 首先，关闭智能机器人（按下按钮 11）。
- 然后，关闭泊位充电器（按下按钮 4）

提示：如您长期不需使用清洁器，请您为智能机器人充满电。

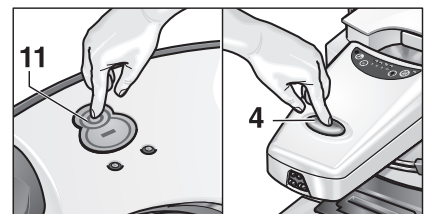

Figure 8

操作

停靠智能机器人

如果您希望智能机器人在下一轮清洁之后，就结束清洁工作。

- 请按下（智能机器人停放按钮 B）

停放指示灯（A）会被激活，当智能机器人第二次回到泊位充电器之后，它将被清空污物箱，充满电，然后自动关闭，并且停机在泊位充电器旁边。

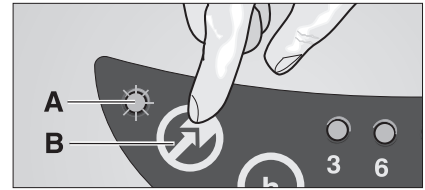

Figure 9

选择清洁时间

如果您希望选择一个特殊清洁时间长度，

- 按 C 钮，直到选定所需的清洁时间。

（默认设置：持续清洁）

按一次——三小时清洁，用于清洁小于 45 平方米的房间

按二次——6 小时清洁，用于清洁 45~90 平方米的房间

按三次——9 小时清洁，用于清洁 80~135 平方米的房间

选定清洁时间长度后，指示灯会闪亮，当清洁时间结束后，智能机器人会自动清空污物箱，停机在泊位充电器前。

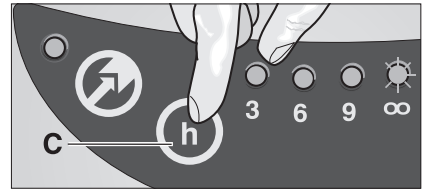

Figure 10

静音模式

选用该种模式，适用于晚上清洁以及您在家的情况下使用。

- 选用该种模式，静音模式指示灯将被激活。泊位充电器将为智能机器人提供八小时低噪清洁与充电服务，然后，泊位充电器将返回到正常操作模式。

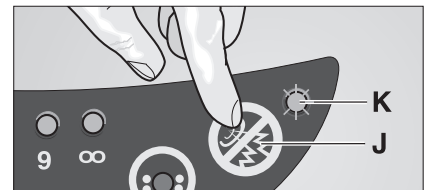

Figure 11

操作程序

操作程序的选择是由污物箱上的光敏元件自动控制。根据污渍的肮脏程度做出选择。根据地板上的污渍程度，智能机器人提供4种不同操作程序满足清洁需要。地板越脏，智能机器人清洁选择程序时间操作越长。若地板上的污渍逐渐减少了，智能机器人也会自动调整到合适的程序。

1、 操作程序——一般清洁 — 智能机器人以一般速度随即清洁
2、 操作程序——个别污渍点 在有污渍的地方，智能机器人以较慢的速度进行清洁
3、 操作程序——个别严重污渍点 在有污渍点的地方，智能机器人来回运作，进行清洁
4、 操作程序——极脏地面 — 智能机器人以圆点为起点，慢速地进行向外来回清洁

提示与技巧

- ① 在第一次清洁时，请关注您的智能机器人，若遇到任何智能机器人不能处理的障碍，为它扫除，以免在清洁过程突然间断。
- ① 在清洁之前，请将地板上松散的物品都移走
- ① 将电线、绳子、窗帘收好，以免智能机器人碰到他们
- ① 若您将设备储存4个月以上，请保证智能机器人中的电池已充满电
- ① 若智能机器人在清洁工作时，您在打电话，或是看电视，请选用静噪模式
- ① 当清洁单个房间时，请关闭房门
- ① 当您需要清洁全部地面时，请确保智能机器人不会被门挡住，而不能清洁门背后的范围。
- ① 当您需要将智能机器人转移到别的地方进行清洁，我们建议您在智能机器人充电期间将它关闭。（污物箱已被清空后）

保养与维护

 在维护之前，请将泊位充电器与智能机器人关闭

泊位充电器

更换泊位充电器的过滤纸包

若过滤纸尘袋指示灯（H）已亮，您必须立即更换泊位充电器内的过滤纸尘袋

- 打开过滤器外盖
- 将过滤尘袋从基座上取出，作为普通家用垃圾丢弃。
- 将新的过滤纸尘袋装入，直到将过滤纸尘袋压入底部。

注意，在没有安置过滤纸尘袋的情况下，请不要启动使用智能机器人。

- 将外盖盖上

注意，当您再次启动智能机器人的时候，过滤纸尘袋指示灯(H)会闪亮，第二次吸尘操作开始。

纸尘袋套装零部件：5 个过滤纸袋，一个电机保护纸质过滤器，
订货号：6.904-257

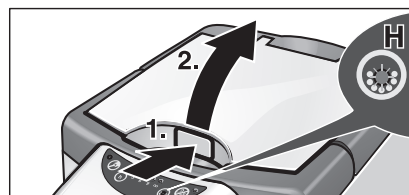

Figure 12

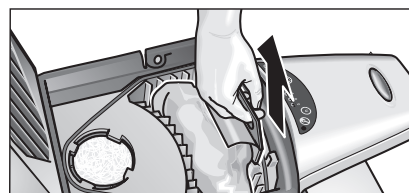

Figure 13

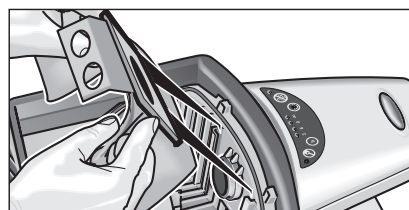

Figure 14

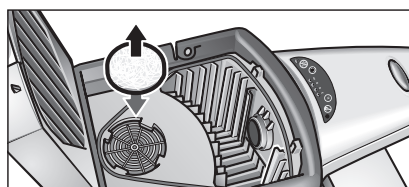

Figure 15

为泊位充电器更换电机保护纸质过滤器

- 若您已更换五次过滤纸袋，请更换引擎保护纸质过滤器(在纸尘袋套装零部件内)

机器人

请按照以下步骤进行所有的维护工作

打开污物箱

- 将智能机器人放在泊位充电器内，排空污物箱
- 将智能机器人放在柔软的物质上
- 打开污物箱的外盖

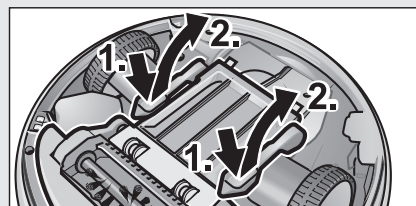

Figure 16

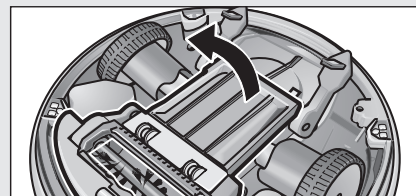

Figure 17

清洁扁平式过滤器

当您更换过滤纸袋的时候，请清洁扁平式过滤器

- 将污物箱内的扁平过滤器取出
- 震动扁平过滤器，或用小刷子清洁它
- 将扁平过滤器重新装回智能机器人中

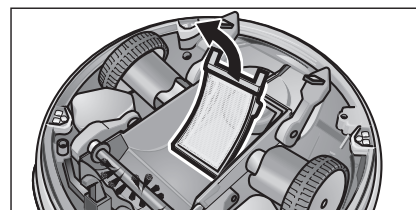

Figure 18

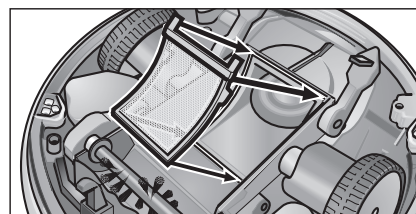

Figure 19

取出滚刷

- 打开污物箱（详见 261 页）
- 从右旋导向槽中向外拉滚刷（1）
- 从横向支承器上拿出滚刷（2）

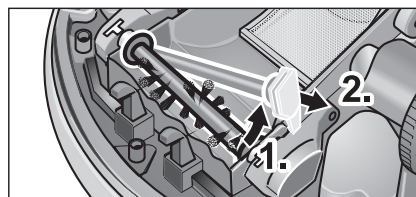

Figure 20

清洁滚刷

滚刷在智能机器人在泊位充电器中充电时，会被自动清洁。您需要亲自将滚刷上缠着的头发与细线取下来，即可。

- 用剪刀沿着滚刷上的凹槽剪断头发与细线
- 将剪断的头发与细线去除

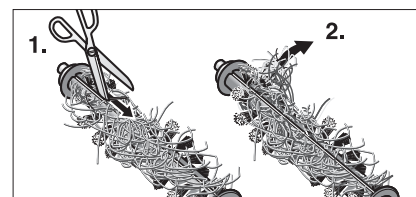

Figure 21

更换新滚刷

- 如果滚刷上的刷毛磨损了，请更换它

保养与维护

装滚刷

- 将滚刷左边先插入（1）
- 将滚刷按入机器，直至到其正确位置（2）

清洁光敏元件

- 使用软布或软刷清洁光敏元件

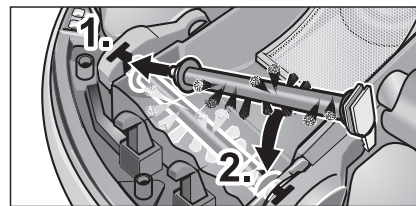

Figure 22

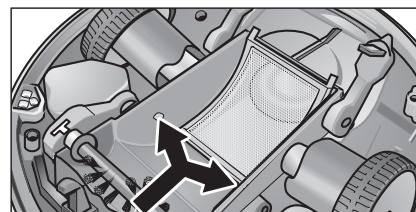

Figure 23

请按照以下步骤结束所有维护工作

安装污物箱外盖

- 将外盖放在污物箱上
- 两边的上锁扣扣好
- 按外盖的前端，保证污物箱安全锁紧了

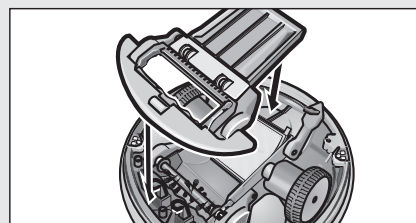

Figure 24

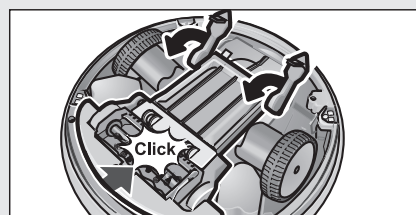

Figure 25

更换电池

请确保只使用凯驰的电池。

- 将电池的两个螺丝钉松开，取出旧电池
- 装入新电池，锁紧螺丝钉

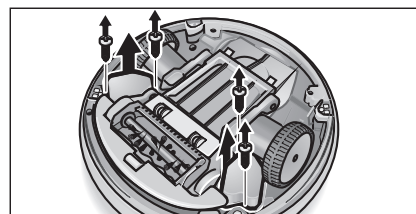

Figure 26

请合理处置旧电池

电池中含有危害环境的有害物质，请不要随便丢弃。请将其投置到合适的回收站点。



请将旧设备合理处置

旧设备中含有可回收利用的有价值材料。请将旧设备合理回收再利用。例如电池，机油以及类似材料不要丢弃到环境中。将旧设备投入合适的收集系统中重新利用。



故障排除

指示灯（12）

绿色	正常操作状态		
	快速闪动（每半秒闪动一次） 慢速闪动（每秒闪动一次） 衡亮	智能机器人找不到方向 智能机器人阻塞了 与您的经销商联系	
问题	故障现状	表现结果	解决方案
动机器人在家具之间找不到返回的路	红灯快速闪动	智能机器人停止工作	移开家具，将智能机器人取出来，先关闭然后再启动重新工作
有坡度的家具	红灯快速闪动	智能机器人迷失方向并停止工作	将智能机器人关闭，并从家具中取出来
智能机器人遇到了家具下的物体，迷失方向	红灯快速闪动	智能机器人停止工作	将智能机器人关闭，取出，放在地板上，重新启动工作
滚刷被缠住，不能工作	红灯慢速闪动	智能机器人在地板上无故停止工作	关闭，捡起机器人，将滚刷上的缠绕物如，玩具，服装等取
清洁效果差，污物根本就没有被清洁	红灯慢速闪动	污物箱已满	清空污物箱
	红灯慢速闪动	滚刷太脏，不能再进行清洁工作了	清洗或更换滚刷
	红灯慢速闪动	滚刷被缠	从滚刷上取下堵塞物
	红灯慢速闪动	滚刷没有正确安置	将滚刷正确安置
	红灯慢速闪动	吸尘口被堵	如需要，检查并清理吸尘入口
智能机器人只清洁部分地板	绿灯常绿	只有一部分地板被清洁	使用软布清洁光敏元件
智能机器人在不平的地毯上上下下震动	绿灯常绿	清洁不彻底	该种设备不适合用于落差大于 20mm 地毯
智能机器人寻找泊位充电器，在清洁中，也不回泊位充电器	绿灯慢速闪动	智能机器人污物箱未 满，却停在了房间中间	启动泊位充电器
智能机器人不回泊位充电器	绿灯慢速闪动	智能机器人污物箱未 满	检查污物箱外盖的位置，将泊位充电器放在平整的表面
吸尘器吸入了湿垃圾		滚刷和过滤器堵塞	将滚刷和过滤器从机器中取出，清洁。如果过滤器是湿的，请不要将其装入机器
在清洁过程中，智能机器人发出刺耳的声音，		清洁效果不好	智能机器人滚刷没有正确内置，关闭机器人，并检查刷子位置

技术参数

泊位充电器

操作电压	220 V (1-50 Hz)
清洁功率	600 W
噪音 (静噪模式)	60 (54) 分贝
过滤纸袋	2 升
规格	500X250X230 mm
重量	5.8 kg

智能机器人

电池容量	1.7 AH
操作电压	12 V
清洁时间	
每次充电后可使用时间	60 分钟
充电时间	10~20 分钟
污物箱容量	0.2 升
规格	280X105 mm
重量	2 kg

保修条款

保修条款由各国的经销公司颁布，在保修期内，可证明为设备材质或生产引起的故障造成的损坏，将得到我们的免费维修。

若在保修期内需要维修，请携带您的设备，附件，及购买证明到您的经销商或附近的消费者服务中心处维修。

常见问题

什么样的地板可以使用这种智能机器人？

这种智能机器人可以使用在所有通用地面。例如，地毯，硬表面（瓷砖，镶木地板等等）若清洁落差高度超过20毫米的地面，请专人照顾。其清洁路线根据不同的地板表面，自动调整。

该智能机器人是否可以清洁家具下部？

该机器为扁平式设计，可专门用于清洁家具下部，例如床，沙发，茶几等等下部的清洁。

智能机器人，如何将收集到的垃圾转移给泊位充电器？

智能机器人安装了一个可由泊位充电器清空的污物箱

泊位充电器如何吸入垃圾？

在泊位充电器中，垃圾被收集到了过滤纸尘袋中。将纸尘袋从泊位充电器中取出的时间根据操作仪表板上的显示进行的。

智能机器人可以吸收多少垃圾？

一般的清洁工作，污物箱可以用达一个小时的清理工作。如果，污物箱已满，智能机器人会提早回到泊位充电器，将污物箱清空，然后，继续工作。

智能机器人如何吸入垃圾？

智能机器人通过吸尘的方式，将垃圾吸入污物箱

智能机器人可否在无人照看的情况下进行工作？

可以，这样绝对没有问题。智能机器人是个全自动设备，不需照看。污物箱也会由泊位充电器进行清空。

充电需要多长时间？

充电时间将根据电池充电以前的状况决定，一般持续15~60分钟。如果是第一次使用，充电时间将是最长的一次。

智能机器人以什么速度前进？

一般而言，智能机器人每秒前进20厘米。若清洁污渍非常严重的地面，将会减慢至一半速度，加强清洗强度。当清洗这样的地面时，智能机器人返回泊位充电器的速度会进一步降低。

智能机器人一个小时内可以清洁多大的面积？

智能机器人一小时可以清洁15平方米的面积。若经常行走的地方，智能机器人会以不同的方向进行反复清洗。

智能机器人如何知道该回泊位充电器了？

当电池的容量降低到一定的水平或污物箱已满，智能机器人会马上回到泊位充电器。

智能机器人需要多久才可以在泊位充电器中排空污物箱？

这个过程大约持续30秒

计算机程序确定在那里操作？我应该注意些什么？

智能机器人只能够进行开与关的操作。你可以在泊位充电器上选择清洁持续时间。并且，您应注意，在执行停机命令之后，智能机器人应停机在泊位充电器附近。

智能机器人以何种方式进行移动？

智能机器人在房间内移动时，按照随机理论。如果遇到障碍物，将会随机选择一个方向，然后进行直走，直到它遇到第二个障碍物。

智能机器人内置了什么装置，用于帮助智能机器人应对障碍？

智能机器人内置了光敏元件。可以发觉到楼阶，可以防止智能机器人跌落。使用特殊的地毯凹槽程序可以帮助智能机器人，在遇到地毯时，不会卡在地毯凹槽中。通过拥有不同的角度转换功能，它也可以在狭窄的角落里找回外出的回路。

如何最有效的进行智能机器人清洁操作？（单独房间，整个公寓）。

智能机器人最有效的清洁是单个房间清洁，注意，请将智能机器人与泊位充电器放置在同一个房间。这样可以缩短智能机器人搜索泊位充电器的时间。这样，用于清洁的时间是最长最有效的。如果你希望清洁整套房子的全部地面。请将泊位充电器置于房子的中部，以便与智能机器人往返。

常见问题

（智能机器人是圆形的。）清洁角落是否有问题？

没有问题，因为智能机器人是持续清洁的。因此，角落内的灰尘堆积，是可以有效被清洁的。

遇到楼梯台阶怎么办？（会不会掉下去）

遇到楼梯：智能机器人内置了光敏元件，当遇到这样有高低或有凹槽的地方，智能机器人会及时转变方向。

遇到台阶：智能机器人可以顺利通过10毫米以下的硬台阶，20毫米的软台阶的。超过此标准，就只能通过绕道来进行清洁了。

在清洁过程中，是否会伤害家具？

不会，家具在清洁过程中，不会受到伤害。但是请注意，智能机器人会移动较轻的，易碎的物质，一些通过电线连接的物体，可能会让智能机器人拉下来，如，电话。请在房间清洁之前，提前准备一下是非常重要的。

智能机器人会不会影响宠物？

由于RC3000噪音轻，并且没有尖锐的声音发出。宠物的问题不用担心。其很好的自控能力，只可能会引起对于宠物的不信任。

考虑到儿童时，应注意些什么？

如果房间内儿童在玩耍，请不要将智能机器人置于该房间。如果智能机器人在进行清洁操作时，儿童坐在智能机器人上，可能会造成智能机器人机械故障。

为什么在某些地方，智能机器人会自动停止工作？

智能机器人只能通过环境复杂较低程度的房间。电线可能会将智能机器人引导系统设入瘫痪程序。这种情况下，智能机器人会在一段时间后，自动关闭。智能机器人背上的红色显示灯会快速闪动。

最好的解决方法是将智能机器人放在一块较空旷的地面上，关闭智能机器人，然后再重新启动它。然后，它就会继续正常工作了。

我如何正确的转移我的智能机器人？

您可以用双手，将智能机器人从地板上抱起，或者，你可以单手握在泊位充电器的手柄上。来转移智能机器人。

如果智能机器人吸进了湿垃圾，怎么办？

如果这样的话，智能机器人的过滤器将会被堵。你必须取出过滤器并清洗它。详见26页如何清洗过滤器。

当我不再房内，如果智能机器人迷失了，怎么办？

什么事也不会发生。智能机器人会自动停止清洁工作。并闪亮显示灯。如果显示灯不再闪亮，表明电量低，需要充电。

Contents

Function and Mode of Operation	16
For Your Safety	17
Quick Reference	18
Operating Controls	19
Preparation	20
Unpacking	20
Installation Notes for the Station	20
Operation	21
Preparation for the Cleaning	21
Initial Operation	21
Turning the Robot Off	21
Parking	22
Selecting the Cleaning Duration	22
Quiet mode	22
Operating Programs	22
Tips and Tricks	23
Maintenance and Care	23
Station	23
Robot	24
Troubleshooting	26
Specifications	27
Warranty	27
Frequently Asked Questions	28
Spare Parts List	31



Attention!

**Do not use the appliance without having read the Operating Instructions.
Retain the Operating Instructions for future reference or for subsequent possessors.**

Function and Mode of Operation

Dear Customer,

thank you very much for purchasing the Kärcher cleaning robot RC 3000.

The RC 3000 is an automatic cleaning robot for the indoor area of private households. It can be used on all common floor coverings for the autonomous, continuous routine cleaning. The appliance consists of two components - a docking station and a mobile robot.

The robot is operated with rechargeable batteries. It moves according to the random method. If the robot bumps into an obstacle, it changes its direction at a random angle. Then, it goes straight ahead until it bumps into the next obstacle. The flat design of the robot allows it also to clean the floor underneath pieces of furniture, such as beds, sofas, cupboards, and wardrobes. The robot is working with optical sensors that detect stairs and steps and prevent the robot from falling down.

The robot provides four operating programs that allow him to automatically adjust to the various degrees of dirt accumulation on the floor. The control of the operating programs is performed by means of sensors located in the dirt receptacle and adjusts depending on the detected degree of dirt accumulation.

If the battery is charged completely, the robot can clean up to 60 minutes. After 20 minutes, the robot (IR receiver) begins to search its station (IR sender). If the robot has not found its station after 60 minutes, it turns off its cleaning functions and exclusively concentrates on the search for its station for another 60 minutes.

The station serves to charge the batteries of the robot and to empty the dirt from the dirt receptacle. In the station, the dirt is collected in a filter bag (2 l). Once the charging process is completed, the robot autonomously leaves the station and continues the cleaning.

Fields of Use

Use the RC 3000 exclusively

- for the cleaning of textile and hard floor coverings in the private household.

Caution: To avoid scratches to highly delicate floorings (such as soft marble), please test it out at some not so visible spot

Do not use the RC 3000 for the cleaning

- of wet floor coverings
- of wash-rooms or other wet rooms
- of stairs
- of tabletops and shelves
- of cellars or attics
- of warehouses, industrial buildings, etc.
- in the open air
- of burning or red hot objects (e.g. cigarettes, hot ashes)

Do not use the RC 3000

- in potentially explosive locations
- in rooms where the air contains inflammable gases of benzene, heating oil, paint thinner, solvents, kerosene, or spirit.
- without supervision in rooms with a burning or glowing fire in an open fireplace
- without supervision in rooms with burning candles
- in rooms that are protected by means of an alarm system or a motion sensor.

Safety Instructions

- Kärcher electrical appliances meet the generally accepted rules of technology and the Technical Plant and Equipment Act (EC Directive 73/23/EEC).
- The mains voltage supplied and the voltage specified on the type plate must be identical.
- Check the faultless condition of the power cord before using it. Do not use the RC 3000 if the power cord shows any damages.
- Always hold the plug rather than the cable when disconnecting the power cord.
- Never touch the mains plug with wet hands (risk of electrical shock).
- Disconnect the mains plug before performing any maintenance work.
- The power cord may only be exchanged by the authorized Kärcher customer service. Only use the original cable (H05 VV- 2 x 0.75).
- Have your appliance exclusively repaired by the authorized customer service.
- Only use accessories and spare parts which have been approved by the manufacturer. The exclusive use of original accessories and original spare parts ensures that the appliance can be operated safely and troublefree.
- Do not leave children unattended in the same room while the RC 3000 is running.
- The appliance is not intended for use by young children or infirm persons without supervision.
- Young children should be supervised to ensure that they do not play with the appliance.
- Never forget that the robot is switched on (risk of stumbling).
- Do not stand or sit on the robot/the station.
- Objects may fall down if the robot bumps into them (this also applies to objects on tables or smaller pieces of furniture).
- The robot may get stuck in telephone cables, electrical cables, tablecloths, strings, belts, etc. In the extreme case, this may cause objects to fall down.
- No liability will be accepted if the appliance is not used for its intended purpose or is incorrectly operated.
- The charging device located on the station may be exclusively used to charge the robot.
- The batteries of the robot may only be charged at the station.

Quick Reference

1. Assembling the RC 3000

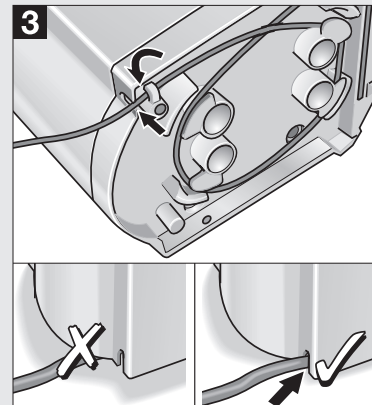
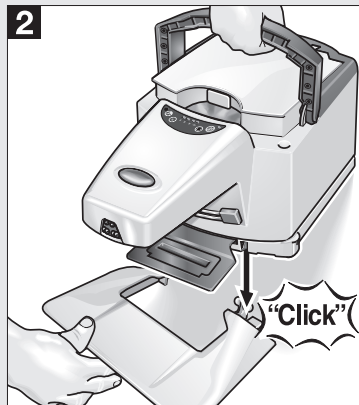
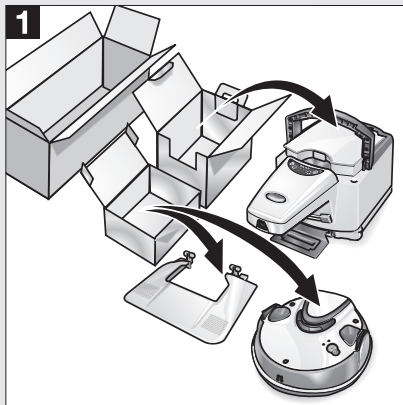

2. Starting the RC 3000

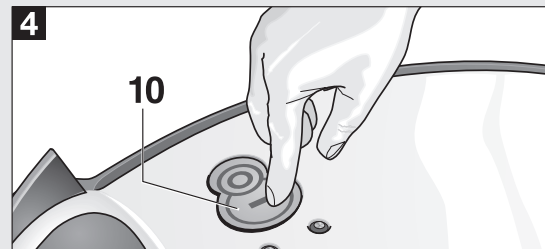
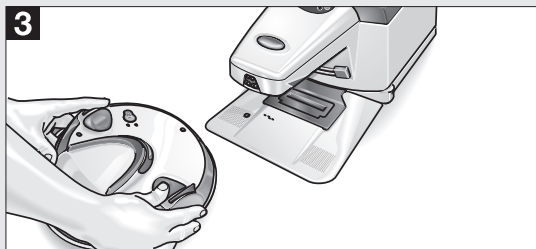
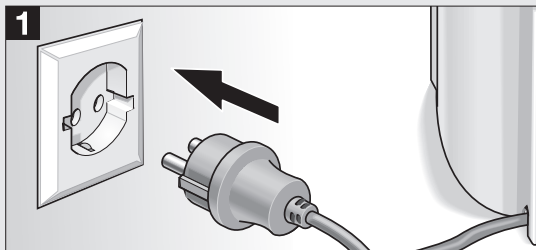

3. Indicator lamps (12)

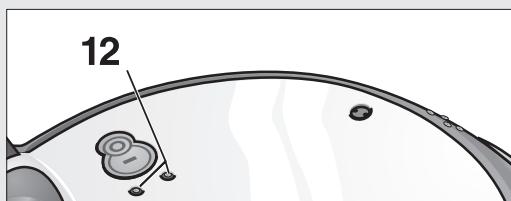

Green	Permanent light blinks slowly (on: 1 sec.; off: 4 sec.) blinks rapidly (on: 0.5 sec.; off: 0.5 sec.)	Cleaning run Robot is searching the station Batteries must be charged
Red	See "Troubleshooting" section, page 26	

Operating Controls

Station for cleaning robot

- 1 Retractable handle for the transport of the station
- 2 Recessed grip to open the filter cover
- 3 Operating panel of the station
- 4 ON/OFF switch of the station
- 5 IR sender
- 6 Suction hole
- 7 Access ramp for the cleaning robot
(to dock onto the station)
- 8 Battery contacts
- 9 Power cord

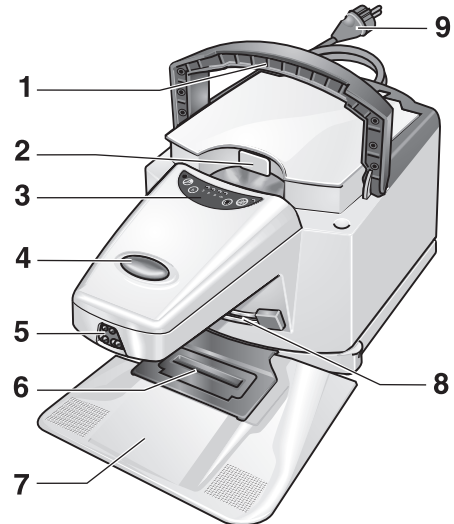

Operating panel of the station (3)

- A Indicator lamp (green) - parking the robot
- B "Parking the robot" button ON/OFF
- C "Select cleaning duration" button
- D Indicator lamp (green) - 3-hour-cleaning
- E Indicator lamp (green) - 6-hour-cleaning
- F Indicator lamp (green) - 9-hour-cleaning
- G Indicator lamp (green) - permanent cleaning
- H Indicator lamp (red) - filter full
- J Button - Quiet mode (ON/OFF)
- K Indicator lamp (green) - quiet mode

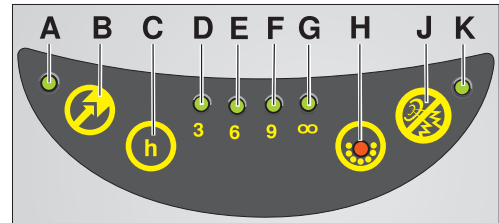

Cleaning robot

- 10 Button - Turn on robot
- 11 Button - Turn off robot
- 12 LEDs (green - operation / red - failure)
- 13 Battery contacts
- 14 Safety bumper
- 15 IR receiver
- 16 Brush
- 17 Optical sensor (4x)
- 18 Battery (2x)
- 19 Locking lever (2x) dirt receptacle
- 20 Cover of the dirt receptacle
- 21 Dirt receptacle

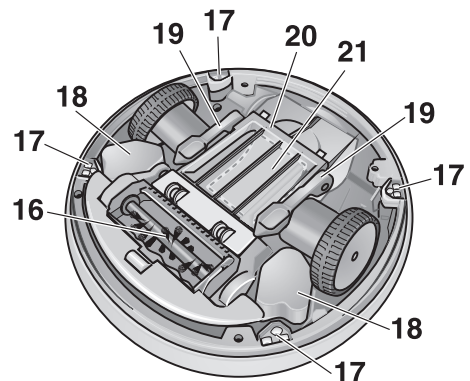
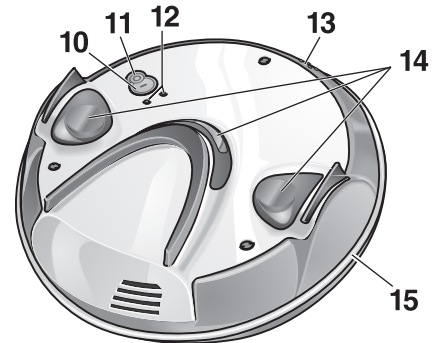

Preparation

Unpacking

When you unpack the system, check that everything is complete. If there are any missing parts or you detect any transport damage when unpacking, please inform your dealer immediately.

Please arrange for the proper disposal of the packaging

The packaging material can be recycled. Please do not place the packaging into the ordinary refuse for disposal, but arrange for the proper recycling.

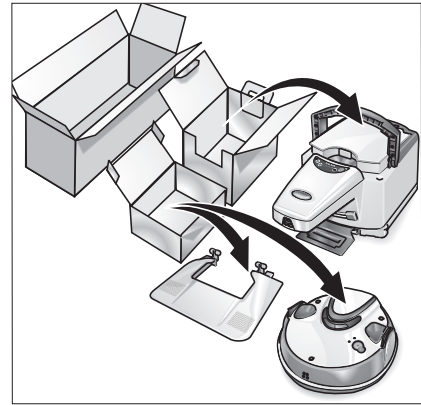

Figure 1: Unpacking the RC 3000

Installing the Access Ramp

- Hold the access ramp tilted.
- Insert the cut-outs of the station into the pins of the access ramp.
- Press the station and the access ramp downwards until the connection locks into place.

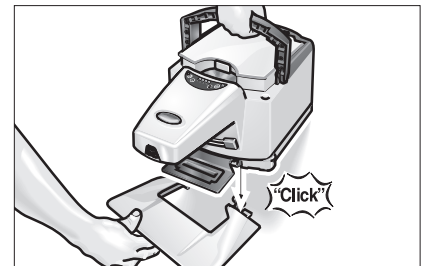

Figure 2: Installing the access ramp

Installation Notes for the Station

When you select the location of the station, please make sure that the robot is very likely to pass the infrared beam again and again to easily find its way back to the station (see Figures 4a and 4b).

- Place the station on a level surface.
 - Do not place any objects directly in front of the station.
 - Do not lay any cables in front of the station (prevents the robot from docking).
 - Uncoil the power cord only to the required length.
 - Secure the remaining power cord in the cable hooks. Please make sure that the power cord is guided through the opening in the housing (Figure 3).
- Connect the mains plug to a wall socket.

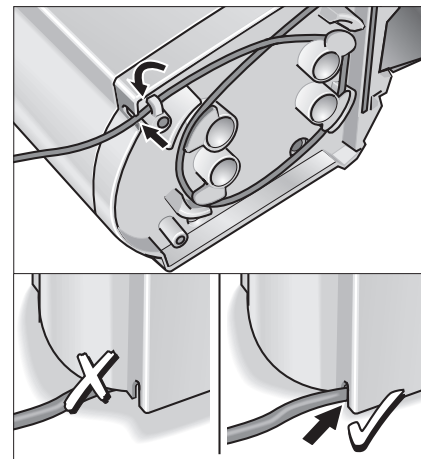

Figure 3: Placing the station

Cleaning a single room

The station is positioned in the room to be cleaned (Figure 4a). The appliance can be adjusted to changing room sizes by means of selecting the cleaning duration (see page 22, "Selecting the Cleaning Duration").

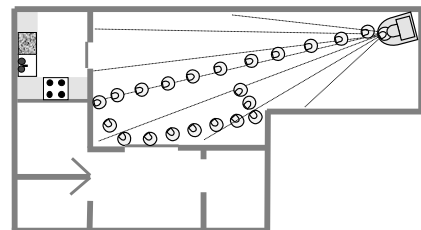

Figure 4a: Cleaning a single room

Cleaning a complete floor

The station is positioned in one room, and several rooms are cleaned (Figure 4b).

Note:

If transitions from one room to the other have a height between 2 cm and 8 cm, then the robot can normally go downward during operations but not upward.

Caution:

For balconies and staircase exits, the inner corners need to be secured if the passage height under the railing is greater than 10 cm

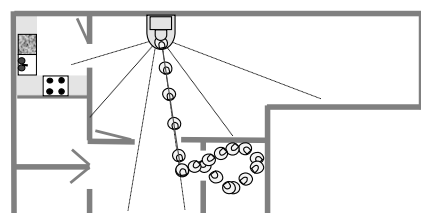

Figure 4b: Cleaning a complete floor

Operation

Preparation for the Cleaning

- Please make sure that there are no obstacles on the floor while the robot is running.

<p>Obstacles can be, for example:</p> <ul style="list-style-type: none"> – Newspapers, books, magazines, paper – Clothes, toys, CDs – Plastic bag – Bottles, glasses – Curtains hanging down on the floor – Bathroom mats 	<p>The following objects are, for example, not considered obstacles:</p> <ul style="list-style-type: none"> – Single cables in the room – Door sills up to a height of 10 mm – Carpet fringes that are shorter than 10 cm
--	---

Initial Operation

- Turn on the station (switch 4).
The permanent cleaning indicator lamp (G) lights up.
- Put the robot on the floor in front of the station.
- Turn on the robot (button 10).
The robot firstly goes to the station to empty the dirt receptacle and to check the charging state of the batteries. If required, the batteries are charged. Then, the robot starts its cleaning run.

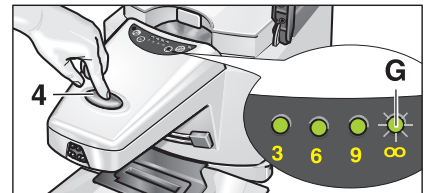

Figure 5: Turning on the station

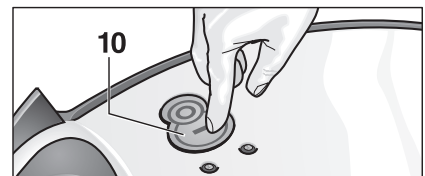

Figure 6: Turning on the robot

Indicator lamps (12)

Green	Permanent light blinks slowly (on: 1 sec.; off: 4 sec.) blinks rapidly (on: 0.5 sec.; off: 0.5 sec.)	Cleaning run Robot searches station Charge batteries!
Red	See "Troubleshooting" section, page 26	

Operation After a Long Rest Period

If the robot is turned on with completely empty batteries, the appliance is not operative. Perform the following steps to put the appliance into operation:

- Place the robot near the station, and press the battery contacts of the robot against the battery contacts of the station for approximately 60 seconds (Figure 7).
In the course of this, the dirt receptacle is emptied.
- Place the robot at a distance of 50 cm in front of the station, and turn it on (button 10).
The robot autonomously goes to the station and is charged. The charging time is approximately 60 minutes.

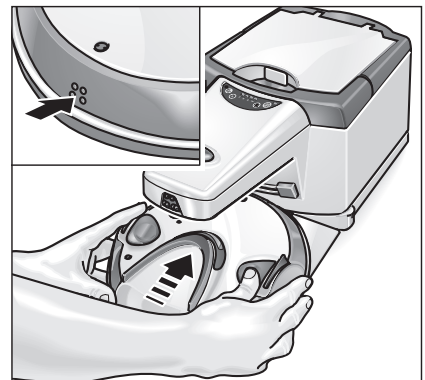

Figure 7: Operation after a long rest period

Turning the Robot Off

If you want the robot to immediately interrupt the cleaning or if you want to move the appliance to a different location, then...

- Turn off the robot (button 11).
- Then, turn off the station (switch 4).

Tip:

If you do not want to use the RC 3000 for a longer period of time, allow the appliance to charge completely.

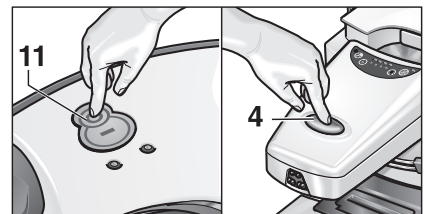

Figure 8: Turning off robot and station

Operation

Parking

If you want the robot to interrupt the cleaning after the next charging cycle, then...

- Press the “Parking the robot” button (B).
The “Parking” indicator lamp (A) is activated.
After its next return to the station, the robot is emptied and charged. Then, the robot is turned off and comes to a standstill in front of the station.

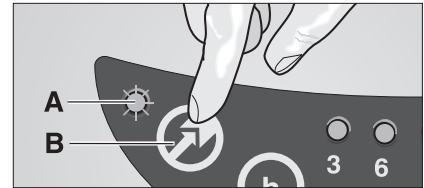

Figure 9: Parking the robot

Selecting the Cleaning Duration

If you want the robot to clean for a specific period of time, then...

- Press the “C” button until the desired cleaning duration is set (default setting: permanent cleaning).

- Press once – 3-hour-cleaning
for rooms smaller than 45 m²
- Press twice – 6-hour-cleaning
for rooms between 45 m² and 90 m²
- Press three times – 9-hour-cleaning
for rooms between 80 m² and 135 m²
- Press four times – permanent cleaning is set again.

The selected cleaning duration begins and is displayed by one of the indicator lamps. If the selected cleaning duration has elapsed, the robot is emptied and charged and then comes to a standstill in front of the station.

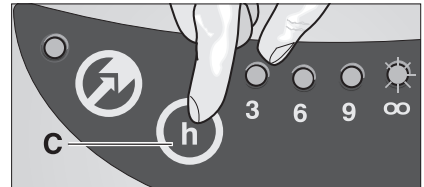

Figure 10: Selecting the cleaning duration

Quiet Mode

Ideal for cleaning runs during the night or if you are at home.

- Press the “Quiet mode” button (B).
The “Quiet mode” indicator lamp (K) is activated. The station cleans the robot for 8 hours with a reduced noise level and a reduced performance. Then, the station returns to normal operation.

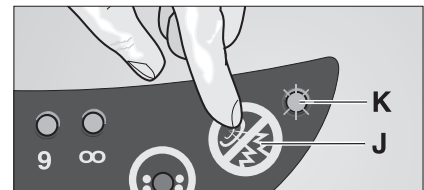

Figure 11: Setting the quiet mode

Operating Programs

The selection of the operating program is **automatically** controlled by sensors located in the dirt receptacle. The selection is made according to the detected degree of dirt accumulation. The robot provides of four operating programs that allow him to automatically adjust to the various degrees of dirt accumulation on the floor. The dirtier the floor, the more extensive the cleaning performed by the robot. If the degree of dirt accumulation has been reduce, the 1st operating program is selected again.

- | |
|--|
| 1. operating program – normal cleaning
– Robot runs according to the random method at normal speed. |
| 2. operating program – individual dirty spot
– Robot slowly moves across the dirty area. |
| 3. operating program – individual very dirty spot
– Robot slowly runs forwards / backwards across the dirty area. |
| 4. operating program – extensive, very dirty area
– Robot runs slowly and radially across the dirty area describing a star. |

Tips and Tricks

- ❗ Observe the robot during the first cleaning cycles. If there are obstacles in the room the robot cannot cope with, you can remove these obstacles in advance to avoid unwelcome interruptions of the cleaning process.
- ❗ Tidy up the rooms prior to the cleaning, do not leave any loose objects on the floor.
- ❗ Tie up cables, strings, and curtains to prevent the robot from pulling them down.
- ❗ If you store the appliance for more than 4 months, please make sure that the batteries are charged completely.
- ❗ If you let the robot work while you are on the phone or watch TV, activate the quiet mode on the station.
- ❗ Room doors should be closed during the cleaning of individual rooms.
- ❗ If you let the robot clean entire floors, please make sure the robot cannot get stuck behind the door.
- ❗ If you want to move the robot to another place, it is recommended to turn off the robot when it is placed in the station for charging (once the dirt receptacle has been emptied).

Maintenance and Care

⚠ Turn off the station and the robot before performing any maintenance work!

Station

Exchanging the filter bag of the station

You must exchange the filter bag if the “Filter full” indicator lamp (H) lights up.

- Open the filter cover.
 - Pull the flap upwards to remove the filter bag from the support. Place the filter bag into the ordinary refuse for disposal.
 - Push the new filter bag into the support until the stop.
- Caution: Never operate the appliance without a filter bag!**
- Close the filter cover.

Spare filter bag kit: 5 filter bags, 1 motor protection filter
Order no.: 6.904-257

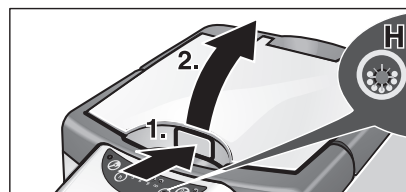

Figure 12: Opening the filter cover

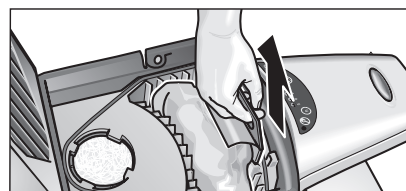

Figure 13: Removing the filter bag

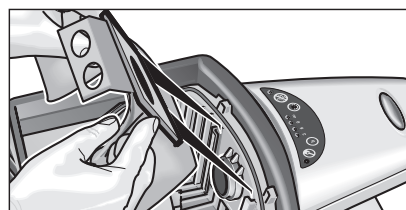

Figure 14: Inserting a filter bag

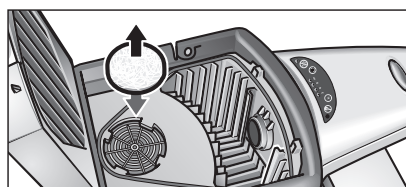

Figure 15: Exchange the motor protection filter

Exchanging the motor protection filter of the charging station

- If you have replaced the filter bag 5 times, also exchange the motor protection filter (included in the spare filter bag kit).

Robot

Cleaning the wheels

- Cleaning the running areas of the wheels when the latter are dirty.
- i** Dirt particles (such as sand, etc.) can get stuck in the running areas and then damage delicate, smooth floorings.

Begin all maintenance works of the robot with the following steps:

Opening the dirt receptacle

- Place the robot into the station to empty the dirt receptacle.
- Put the robot on a soft base.
- Open both locking levers of the dirt receptacle.
- Remove the cover of the dirt receptacle.

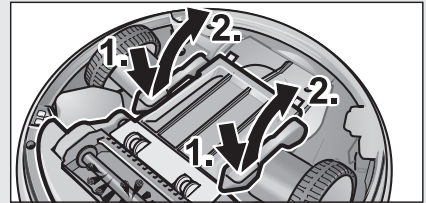

Figure 16: Opening the locking lever

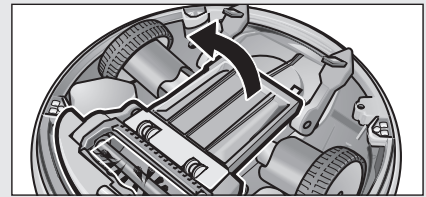

Figure 17: Removing the dirt receptacle cover

Cleaning the flat filter

Clean the flat filter every time you exchange the filter bag.

- Remove the flat filter from the dirt receptacle.
- Shake out the flat filter, or clean it using a small brush.
- Reinsert the flat filter so that the tabs are pointing toward the locking lever.

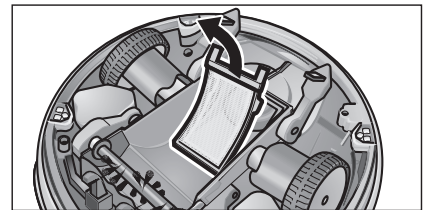

Figure 18: Disassembling and cleaning the flat filter

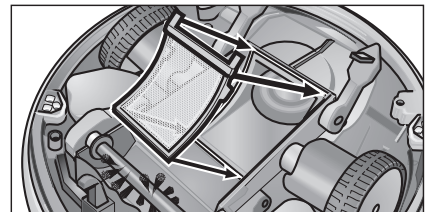

Figure 19: Installing the flat filter

Removing the brush

- Open the dirt receptacle (see above).
- Then, pull the brush out of the right-handed guide (1).
- Afterwards, pull the brush out of the lateral support (2).

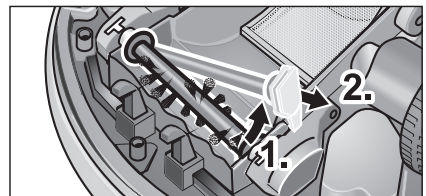

Figure 20: Removing the brush

Cleaning the brush

The dirty brush is automatically cleaned during each cleaning operation in the station. You can manually remove remaining hairs and wrapped up threads.

- Use a pair of scissors to cut along the cutting edge of the brush roll.
- Remove the wrapped up threads/hairs.

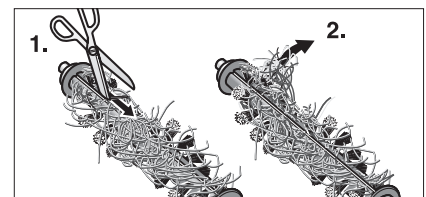

Figure 21: Cleaning the brush

Exchanging the brush

If the bristles are worn out, you must replace the brush.

Maintenance and Care

Inserting the brush

- Insert the brush into the support on the left side (1).
- Press the brush into the right-hand guide with the hook pointing downward until it locks into place (2).

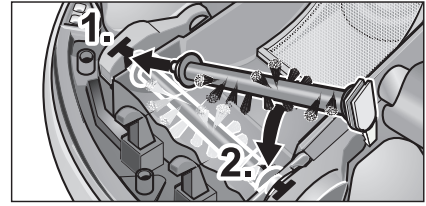

Figure 22: Inserting the brush

Cleaning the dust sensors

- Clean the dust sensors using a soft cloth or a paintbrush.

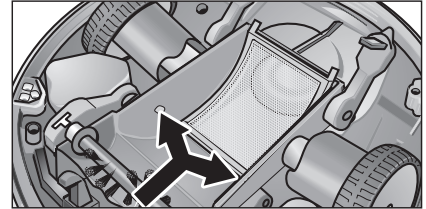

Figure 23: Cleaning the dust sensors

Finish all maintenance works of the robot with the following steps:

Installing the dirt receptacle cover

- Put the cover onto the dirt receptacle.
- Close both locking levers.
- In addition, press on the front side of the cover to ensure the dirt receptacle is closed safely.

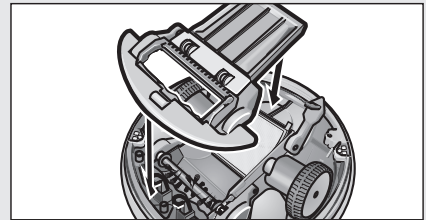

Figure 24: Installing the dirt receptacle cover

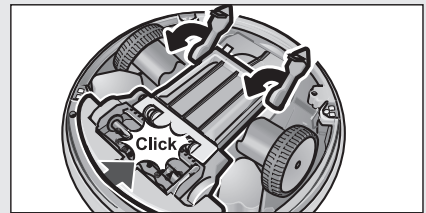

Figure 25: Closing the locking lever

Exchanging the batteries

Use only original Kärcher batteries.

- Release the two screws on the two batteries, and remove the old batteries.
- Insert the new batteries, and fasten them with the screws.

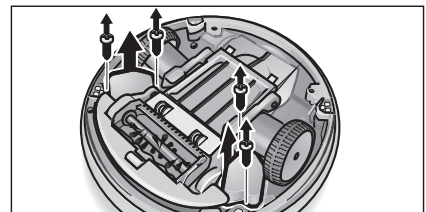

Figure 26: Exchanging the batteries

Please arrange for the proper disposal of the batteries.

Batteries contain substances that must not enter the environment. Please dispose your batteries using appropriate collection systems.



Please arrange for the proper disposal of the old appliance

Before that, first remove the two in-built batteries. Old appliances contain valuable materials that can be recycled. Please dispose your old appliances using appropriate collection systems.



Troubleshooting

Indicator lamps (12)

Green	normal operating state	
Red	blinks rapidly (on: 0.5 sec.; off: 0.5 sec.)	Robot got stuck
Red	blinks slowly (on: 1 sec.; off: 4 sec.)	Robot is choked
Red	Permanent light	Call your service

Problem	Signal	Consequence	Solution
Robot does not find its way out of niches between pieces of furniture	red quickly	Robot stops	Try to re-locate pieces of furniture; get the robot out of the niche, turn it off and then on again.
Gently rising furniture	red quickly	Robot got stuck and stops	Turn off the robot and remove it from the object on which it got stuck.
Robot got stuck underneath items of furniture	red quickly	Robot stops	Turn off the robot and get it out; place it on the floor and turn it on again.
<i>Loose objects have been taken up by the brush and are now blocking the brush</i>	red slowly	Robot stops in the middle of the room without reason	Turn off the robot, turn the robot up, and carefully remove the objects taken up by the brush; loose object include: Toys, clothes, ...
Bad cleaning result, dirt is not absorbed anymore	red slowly	Dirt receptacle is full	Clean the dirt receptacle.
	red slowly	Brush is too dirty or worn out	Clean or exchange the brush.
	red slowly	Brush is blocked	Carefully remove blocking objects from the brush.
	red slowly	Brush has not been inserted correctly	Control the position of the brush
	red slowly	Suction outlet of the station is clogged	Check the suction outlet of the station and clean it, if necessary.
Roboto only describes a star during its turn	green permanent light	Only a specific area/location is cleaned	Clean the dust sensors using a soft cloth.
Robot runs unevenly on carpets, bobs up and down	green permanent light	Uneven cleaning	This operation is normal on deep-piled carpets (> 20 mm). The appliance is not defect.
Robot does not find the station	green slowly	Station has been placed at a wrong position in the room	Re-position the station. (see "Installation Notes for the Station")
Robot does not dock onto the station	green slowly	Robot is not emptied	Check the position of the dirt receptacle cover. Place the station on a level surface
Robot has absorbed wet dirt	--	Brush and filter of the robot become blocked	Remove brush and filter from the robot and clean thoroughly. The filter on the robot must not be inserted into the robot if it is wet.
Robot makes a creaking sound during the cleaning	--	Bad cleaning result	Robot brush is not inserted correctly. Turn off the robot, and check the position of the brush

Troubleshooting

Problem	Signal	Consequence	Solution
Cleaning results are poor.	--	Brush has worn-off.	Replacing the brush
Robot blocked in station or robot is defective	Station: All LEDs are blinking	Robot remains docked in the station even after the charging period is over	Remove any object that is blocking the path. Switch off the station and switch it on again. Give it for servicing.
Internal or external short-circuit of the charging contact strip	Station: All LEDs are blinking		Give it for servicing.

Specifications

Station:

Operating voltage	220-240 V
Cleaning power	600 Watt
Sound level (quiet mode)	60 (54) dB(A)
Filter bag	2 l
Dimensions	500 x 250 x 230 mm
Weight	5.8 kg

Robot:

Battery capacity (NiMH)	1.7 Ah
Operating voltage	12 V
Cleaning time per battery charge up to	60 min
Charging time	10-20 min
Dirt receptacle	0,2 l
Dimensions	ø 280 x 105 mm
Weight	2.0 kg

Warranty

The warranty terms issued by the competent marketing company apply to the individual countries. We will repair potential failures of the appliance within the warranty period free of charge, provided that such failure is caused by faulty material or defects in fabrication.

In the event of a warranty claim please contact your dealer or the nearest authorized Customer Service centre. Please submit the appliance, including all accessories, and the proof of purchase.

Frequently Asked Questions

For which type of floor coverings can I use the robot?

The robot can be used on all common surfaces, such as carpets and hard surfaces (tiles, parquet, etc.). With respect to extremely deep-piled carpets (> 20 mm), specific restrictions apply. The moving sweeping edge is automatically adjusted to different floor coverings.

Is it problematic to perform a cleaning underneath pieces of furniture?

No. Due to its compact and flat design the robot is able to clean underneath pieces of furniture, such as beds, sofas, and wardrobes.

How does the robot transport the absorbed dirt to the station?

The robot is equipped with a dirt receptacle that is regularly emptied by the station.

How is the dirt absorbed in the station?

In the station, the dirt is collected in a conventional filter bag (2 litres).

The exchange intervals are flexible and are reported to the user in a timely manner by means of a signal device on the display.

How much dirt can the robot absorb?

In case of a normal degree of soiling, the dirt receptacle is sufficient for one hour of cleaning. If this should not be sufficient in the individual case, the robot simply returns to the station earlier, disposes of the dirt and carries on working.

How is the absorption of dirt in the robot performed?

The dirt is swept into the dirt receptacle of the robot by means of vacuum-supported sweeping.

Can the robot clean in the apartment / house without supervision?

Yes, this is possible without any problems.

The robot is an autonomous system and does not require any intervention. The dirt receptacle is emptied at the station.

How long does it take until the robot is charged or operative?

The charging time is between 15 and 60 minutes according to the charging state of the battery before the charging. In case of the initial operation, the robot certainly has the longest charging time.

At which speed does the robot move?

By default, the robot runs at 20 cm per second. If it cleans very dirty spots, the speed is reduced by half to intensify the cleaning. The same applies to the final approach to the station to allow the robot to precisely manoeuvre in.

How many square meters can the robot clean within one hour?

The robot can clean up to 15 qm per hour. Many spots, in particular the frequently used paths are cleaned repeatedly from different directions.

How does the robot know when it must return to the station?

The robot returns to the station as soon as the battery voltage has reached a specific level or if the dirt receptacle is full.

How long does it take to empty the robot at the station?

The process takes approximately 30 seconds.

Where is the robot programmed? What do I have to pay attention to?

The robot can only be turned on or off. You can select the cleaning duration at **the station**. In addition, you can specify that the robot should not leave the station after the next approach to the station (parking function).

According to which principle does the robot move?

The robot moves through the room according to the random principle. If he bumps into an obstacle, it turns at any angle and then goes straight until it bumps into the next obstacle.

Frequently Asked Questions

Which tools are present that help the robot to cope with obstacles?

The robot is equipped with sensors that detect stairs and prevent the robot from falling down. Using a special carpet fringe program the robot does not get stuck in carpet fringes. Thanks to the different rotating and driving angles, it also finds its way out of narrow corners.

What is the most efficient way to operate the robot (individual rooms, entire apartment)?

It is most efficient to let the robot clean individual rooms, i.e. station and robot are located within the same room. This reduces the searching time during the return to the station, the share of the effective cleaning time is, therefore, the highest possible.

If you want to clean entire floors, the station should be placed at a central spot of the apartment to enable the robot to easily return to the station.

Are corners cleaned without any problems (the robot is round)?

No, but due to the continuous cleaning, the formation of dirt is substantially reduced. Thus, an accumulation of dirt in corners is effectively avoided.

What happens at stairs / steps (risk of falling down)?

Stairs: The robot works with optical sensors that detect half-landings and signal the robot that it must change its direction.

Steps: The robot is able to deal with hard steps up to 10 mm and soft steps up to 20 mm in both directions.

Caution: Do not leave loose objects (such as newspapers, clothes) on the stairs and terraces or let them project as this can impair the functioning of the sensors. – **Risk of falling**

Can the furniture etc. be damaged?

No. Damages of the items of furniture can be excluded. Please note, however, the lightweight and fragile objects may be touched and moved by the robot. Objects that are equipped with a cable, may be pulled down from furniture (e.g. telephone). It is important to prepare the room in such a manner that it is suitable for robots.

How do pets react to the robot?

As the RC 3000 is not noisy and does not work with ultrasound, problems with pets are not to be expected. The self-movement behaviour only arises the mistrust of the pets.

What is important with respect to children?

The robot should not be left unattended if children are playing in the same room. Mechanical damages are likely if children sit on the robot while it is in operation.

Why does the robot stop in some situations?

The robot is only able to get out of tricky situations to a certain degree. Piled cables can induce him to hopeless manoeuvres. In this case the robot turns off automatically after a specific period of time. The red signal on the robot lights up quickly.

The best solution is to place the robot on a free area and turn it off and on again. Then, it continues its cleaning run without problems.

How do I transport my robot properly?

You can lift the robot from the floor using both hands, or you carry it by putting one hand into the relief of the brush.

What happens if the robot has swept up wet dirt?

As a result, the filter becomes blocked. You have to remove the filter from the robot and clean it (see page 26, "Cleaning the flat filter").

What happens if the robot gets stuck while I am not at home?

Nothing can happen. The robot stops at this point and displays the signal for being stuck. If no lamp is blinking anymore, the batteries are low and must be charged.

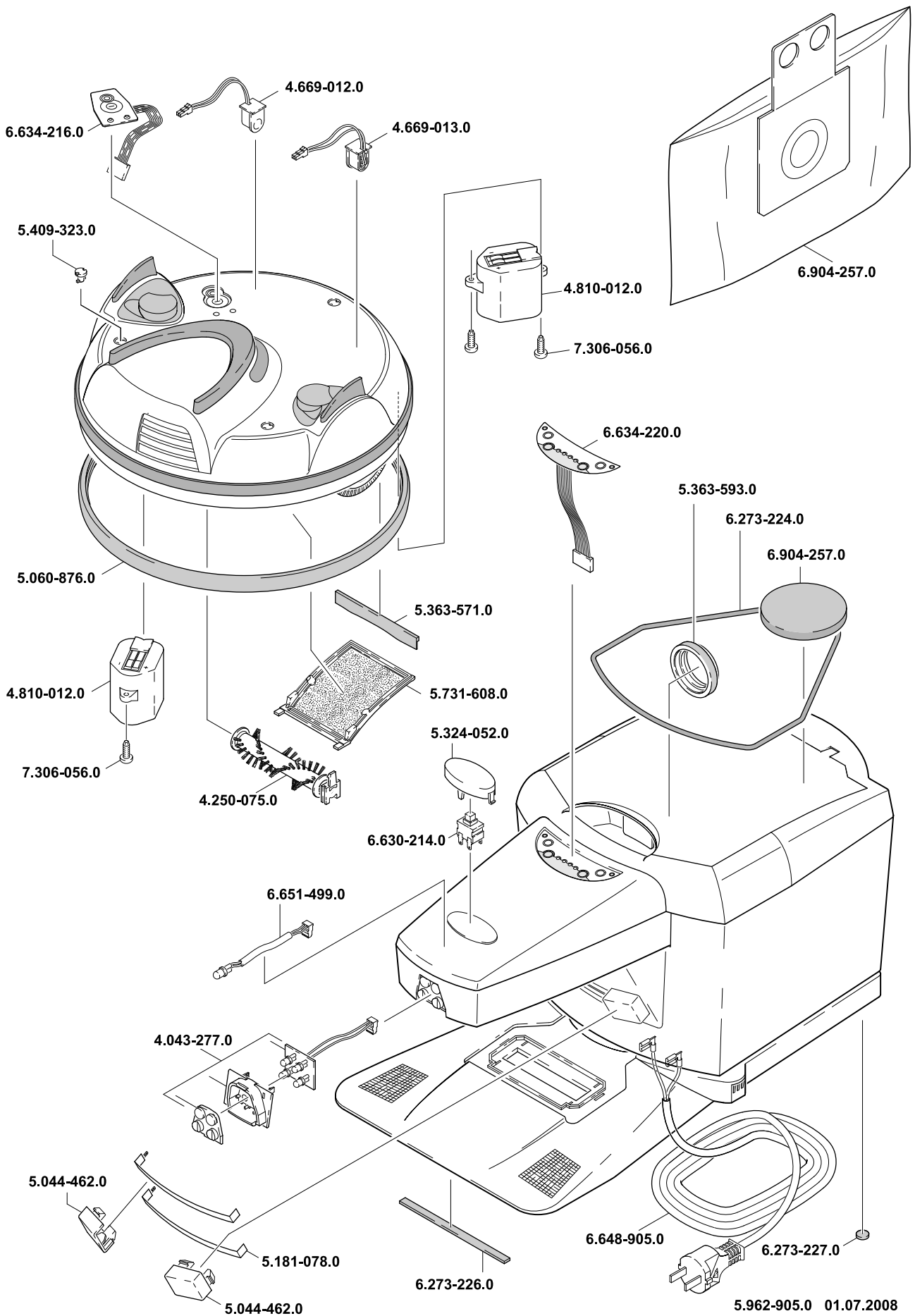

A
Alfred Kärcher Ges.m.b.H.
Lichtblaustraße 7
1220 Wien
☎ (01) 25 06 00

AUS
Kärcher Pty. Ltd.
40 Koornang Road
Scoresby VIC 3179
☎ (03) 9765 - 2300

B / LUX
Kärcher N.V.
Industrieweg 12
2320 Hoogstraten
☎ 0900 - 33 444 33

BR
Kärcher Indústria e Comércio Ltda.
Av. Prof. Benedito Montenegro 419
CEP 13.140-000 - Paulínia - SP
☎ 0800 17 61 11

CH
Kärcher AG
Industriestraße 16
8108 Dällikon
☎ 0844 850 863

CZ
Kärcher spol. s.r.o.
Za Mototechnou 1114/4
155 00 Praha 5 -Stodůlky
☎ (02) 3552-1665

D
Alfred Kärcher GmbH & Co. KG
Service-Center Gissigheim
Im Gewerbegebiet 2
97953 Königheim-Gissigheim
☎ (07195) 903 20 65

DK
Kärcher Rengøringsystemer A/S
Gejlhavgård 5
6000 Kolding
☎ 70 20 66 67

E
Kärcher S.A.
Pol. Industrial Font del Radium
Calle Doctor Trueta 6-7
08400 Granollers (Barcelona)
☎ 902 17 00 68

F
Kärcher S.A.S.
5 Avenue des Coquelicots
Z.A. des Petits Carreaux
94865 Bonneuil-sur-Marne
☎ (01) 43 99 67 70

FIN
Kärcher OY
Yrittäjätie 17
01800 Klaukkala
☎ 0207 413 600

GR
Kärcher Cleaning Systems A.E.
31-33, Nikitara & Konstantinoupoleos str.
13671 Acharnes
☎ 210 - 23 16 153

GB
Kärcher(UK) Limited
Kärcher House
Beaumont Road
Banbury
Oxon, OX16 1TB
☎ 01295 752200

H
Kärcher Hungária Kft
Tormásrét ut 2.
2051 Biatorbágy
☎ (023) 530-640

HK
Kärcher Limited
Unit 10, 17/F.
APEC Plaza
49 Hoi Yuen Road
Kwun Tong, Kowloon
☎ (02) 357-5863

I
Kärcher S.p.A.
Via A. Vespucci 19
21013 Gallarate (VA)
☎ 848 - 99 88 77

IRL
Kärcher Limited (Ireland)
12 Willow Business Park
Nangor Road
Clondalkin
Dublin 12
☎ (01) 409 77 77

KOR
Kärcher Co. Ltd. (South Korea)
Youngjae B/D, 50-1, 51-1
Sansoo-dong, Mapo-ku
Seoul 121-060
☎ 032-465-8000

MAL
Kärcher Cleaning Systems Sdn. Bhd.
No. 8, Jalan Serindit 2
Bandar Puchong Jaya
47100 Puchong, Selangor
☎ (03) 5882 1148

N
Kärcher AS
Stanseveien 31
0976 Oslo
☎ 24 17 77 00

NL
Kärcher BV
Postbus 474
4870 AL Etten-Leur
☎ 0900-33 444 33

NZ
Kärcher Limited
12 Ron Driver Place
East Tamaki, Auckland
☎ (09) 274-4603

PRC
Kärcher Cleaning Systems Co., Ltd.
Part B, Building 30,
No. 390 Ai Du Road
Shanghai Waigaoqiao 200131
☎ (021) 5046-3579

P
Neoparts Com. e Ind. Automóvel, Lda.
Largo Vitorino Damásio. 10
1200 Lisboa
☎ (21) 395 0040

PL
Kärcher Sp. z o.o.
Ul. Stawowa 140
31-346 Kraków
☎ (012) 6397-222

RUS
Kärcher Ltd.
Vienna House
Strastnoi Blv. 16
107031 Moscow
☎ 095-933 87 48

S
Kärcher AB
Tagenevägen 31
42502 Hisings-Kärä
☎ (031) 577-300

SGP
Kärcher Asia Pacific Pte. Ltd.
5 Toh Guan Road East
#01-00 Freight Links Express Distripark
Singapore 608831
☎ 6897-1811

TR
Kärcher Servis Ticaret A.S.
9 Eylül Mahallesi
307 Sokak No. 6
Gaziemir / Izmir
☎ (0232) 252-0708

TWN
Kärcher Limited
5F/6. No.7
Wu-Chuan 1st Rd
Wu-Ku Industrial Zone
Taipei County
☎ (02) 2299-9626

UA
Kärcher Ukraine
Kilzeva doroga, 9
03191, Kyiv
☎ (044) 5947575

UAE
Kärcher FZE
Jebel Ali Free Zone
RA 8, XB 1, Jebel Ali, Dubai
☎ (04) 8836-776

ZA
Kärcher (Pty.) Limited
144 Kuschke Street
Meadowdale
Edenvale 1614
☎ (011) 574-5360

02/2008

 **KÄRCHER**[®]
www.kaercher.com