

SEARS

OWNER'S MANUAL

MODEL NO.
559.741720

Caution:
Read and Follow
all Safety Rules
and Instructions
Before Operating
This Equipment

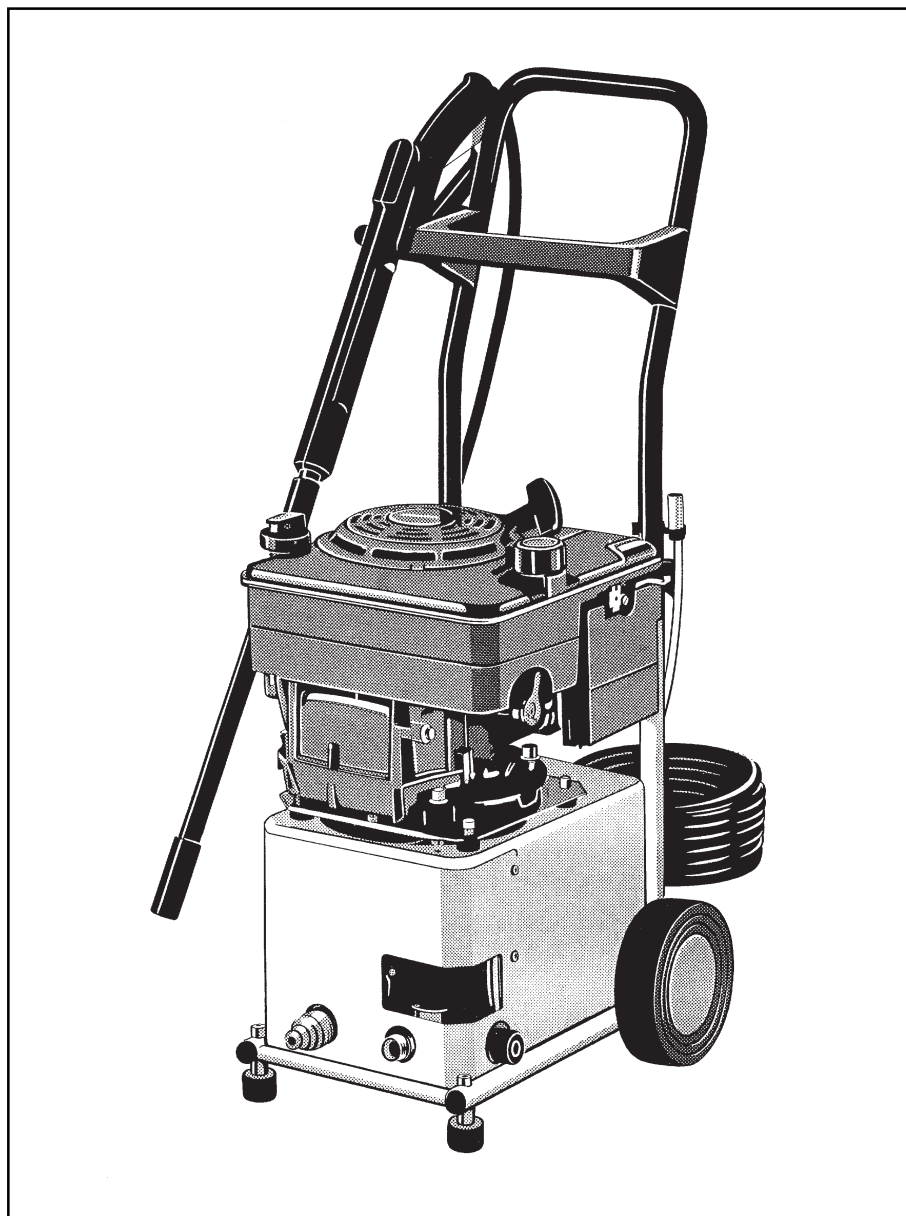

CRAFTSMAN® 1750

5 HORSEPOWER HIGH PRESSURE WASHER

- Assembly
- Operation
- Customer Responsibilities
- Service and Adjustments
- Repair Parts

SAFETY RULES



CAUTION: ALWAYS DISCONNECT SPARK PLUG WIRE AND PLACE WIRE WHERE IT CANNOT CONTACT SPARK PLUG TO PREVENT ACCIDENTAL STARTING WHEN SETTING UP, TRANSPORTING, ADJUSTING OR MAKING REPAIRS.



IMPORTANT

- Read this operator's manual carefully, become familiar with the controls and know how to operate your High Pressure Washer.
- Do not allow children to use your High Pressure Washer. Never allow adults to use the High Pressure Washer without proper instructions.
- Keep the area of operation clear of all persons, especially small children and pets.
- Use the High Pressure Washer only as the manufacturer intended and as described in this manual.
- Do not operate High Pressure Washer if it has been dropped or damaged in any manner. Always have damage repaired before using your High Pressure Washer.
- Do not use accessory attachments that are not recommended by the manufacturer. Use of such attachments may be hazardous.
- Always wear safety glasses or eye shields when starting and while using your High Pressure Washer.
- Dress properly. Do not operate High Pressure Washer when barefoot or wearing open sandals. Wear only solid shoes with good traction when spraying.
- Check fuel tank before starting engine. Do not fill tank indoors, when the engine is running, or when the engine is hot. Allow the engine to cool for several minutes before filling the fuel tank. Clean off any spilled gasoline before starting the engine.
- Spray only in daylight.
- Always stop the engine whenever you leave or are not using your High Pressure Washer.
- Keep your eyes and mind on your High Pressure Washer and the area being sprayed. Do not let other interests distract you.
- Never direct discharge of material toward bystanders nor allow anyone near the High Pressure Washer while you are spraying.
- Before cleaning, inspecting, or repairing your High Pressure Washer, stop the engine and make absolutely sure all moving parts have stopped. Then disconnect the spark plug wire and keep it away from the spark plug to prevent accidental starting.
- Do not change the governor settings or overspeed the engine. Engine damage or personal injury may result.
- Do not run the engine indoors. Exhaust fumes are dangerous.
- Never operate your High Pressure Washer without proper guards, or other safety devices, in place.
- Check the engine mounting bolts often to be sure they are tightened properly.
- Check all bolts, nuts and screws at frequent intervals for proper tightness to be sure sprayer is in safe working condition.
- Keep all safety devices in place and working.
- To reduce fire hazard, keep the engine free of excessive grease and oil.
- Allow engine to cool before storing in any enclosure.
- Never store High Pressure Washer with gasoline in the tank inside a building where fumes may reach an open flame or an ignition source such as hot water heater, space heater clothes dryer, etc.



LOOK FOR THIS SYMBOL TO POINT OUT IMPORTANT SAFETY PRECAUTIONS. IT MEANS – ATTENTION!!! BECOME ALERT!!! YOUR SAFETY IS INVOLVED

CONGRATULATIONS on your purchase of a Sears Craftsman high pressure washer. It has been designed, engineered and manufactured to give you the best possible dependability and performance.

Should you experience any problems you cannot easily remedy, please contact your nearest Sears Service Center/Department. Sears has competent, well trained technicians and the proper tools to service or repair this unit.

Please read and retain this manual. The instructions will enable you to assemble and maintain your sprayer properly. Always observe the "SAFETY RULES".

MODEL NUMBER: 559.741720

SERIAL NUMBER: _____

DATE OF PURCHASE: _____

THE MODEL AND SERIAL NUMBERS WILL BE FOUND ON A DECAL ATTACHED TO THE HIGH PRESSURE WASHER.

YOU SHOULD RECORD BOTH SERIAL NUMBER AND DATE OF PURCHASE AND KEEP IN A SAFE PLACE FOR FUTURE REFERENCE.

CUSTOMER RESPONSIBILITIES

- Read and observe the safety rules.
- Follow a regular schedule in maintaining, caring for, and using your High Pressure Washer.
- Follow the instructions under "Customer Responsibilities" and "Storage" sections of this Owner's Manual.

PRODUCT SPECIFICATIONS

HORSEPOWER	5 HP
GASOLINE CAPACITY (unleaded)	0.37 US gal
GASOLINE CONSUMPTION	0.48 US-gal/h
OIL (1.25 PINT CAPACITY)	SAE 30 (above 32 °F) SAE 5W-30 (below 32 °F)
SPARK PLUG (GAP .030 in)	Champion J19LM
RECOMMENDED RPM	idle 2000 rpm under load 3100 rpm
TORQUE (MAX.) @ 2400 rpm	6.1 FT.-Lbs.
BORE	2 11/16 in.
STROKE	2 3/64 in.
DISPLACEMENT	11.57 cu. in.
OUTLET PRESSURE	1750 psi
FLOW RATE	2.5 gpm
DETERGENT INTAKE	0.2 gpm
WATER SUPPLY TEMPERATURE	MAX. 140 °F
SUCTION HEIGHT with cold water (50 °F)	3 ft.
LENGTH	18 1/2 in
WIDTH	14 in
HEIGHT	36 in
WEIGHT (without accessories)	55 lbs

WARNING:

A spark arrester must be added to the muffler of this engine if it is to be used on any forest covered, brush covered or grass covered unimproved land. The arrester must be maintained in effective working order by the operator.

In the State of California the above is required by law (Section 4442 of the California Public Resources Code). Other states may have similar laws. Federal laws apply on federal lands. A spark arrester for the muffler is available through your nearest Sears authorized service center.

ONE YEAR LIMITED WARRANTY ON CRAFTSMAN HIGH PRESSURE WASHER

For one year from the date of purchase, when this Craftsman High Pressure Washer is maintained and operated according to the instructions in the owner's manual, Sears will repair, free of charge, any defect in material and workmanship.

If this Craftsman High Pressure Washer is used for commercial purposes, this warranty applies for only 90 days from the date of purchase. If this Pressure Washer is used for rental purposes, this warranty applies for only 30 days from the date of purchase.

This warranty does not cover:

- Expendable items which become worn during normal use.
- Repairs necessary because of operator abuse or negligence, including bent crankshafts and the failure to maintain the equipment according to the instructions contained in the owner's manual.

WARRANTY SERVICE IS AVAILABLE BY RETURNING THE CRAFTSMAN HIGH PRESSURE WASHER TO THE NEAREST SERVICE CENTER/DEPARTMENT IN THE UNITED STATES. THIS WARRANTY APPLIES ONLY WHILE THE PRODUCT IS IN USE IN THE UNITED STATES.

This warranty gives your specific legal rights, and you may also have other rights which vary from state to state.

SEARS, ROEBUCK AND CO., D/817 WA, Hoffman Estates, IL. 60179

TABLE OF CONTENTS

SAFETY RULES	2
PRODUCT SPECIFICATIONS	3
WARRANTY	3
TABLE OF CONTENTS	4
INDEX	4
ACCESSORIES	5
PACKING LIST	5
ASSEMBLY	6
OPERATION	7
CUSTOMER RESPONSIBILITIES	11
SERVICE AND ADJUSTMENTS	14
STORAGE	15
TROUBLE - SHOOTING	16

INDEX

Assembly	6
Changeover Nozzle	9
Customer Responsibilities	3
Engine	
Air Cleaner	12
Before Starting	8
Carburetor Adjustments	14
Maintenance	11
Oil Change	13
Operation	8
Spark Plug	13
Storage	15
Maintenance Schedul	11
Operation	
Before Starting	8
Cleaning Tips	10
How to Use Your Power Washer	9
Know Your Power Washer	7
To Start Engine	8

Pump	
Service and Adjustments	14
Storage	15
Repair Parts	14
Safety Rules	2
Service and Adjustments	
Engine Speed	14
Carburetor	14
Pump	14
Specifications	3
Storage	
Engine	15
Sprayer	15
Trouble Shooting	16
Warranty	3
Washer	
Customer Responsibilities	3
Maintenance	11



ACCESSORIES

These accessories were available when this Pressure Washer was produced. They are also available at most Sears retail outlets and service centers.

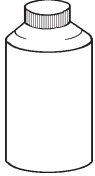
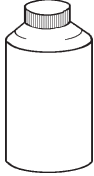
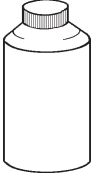
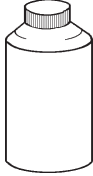
CLEANING SOLUTIONS

HOUSE WASH  74273	DECK WASH  74274	VEHICLE WASH  74275	DEGREASER  74276
--	---	--	---

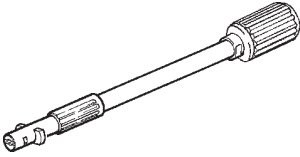
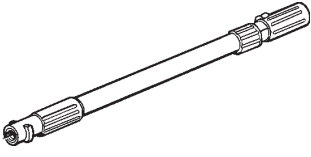
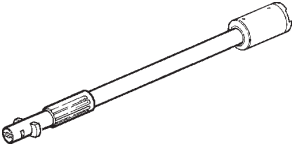
ACCESSORIES

ROTATING NOZZLE  74173	HOUSE WASHING WAND  74174	18" EXTENSION WAND  74175	SUCTION HOSE ASSY  74188
---	--	---	---

PACKING LIST

- | | | |
|------------------------------------|--------------------------|--|
| 1 1 ea Washer assy | 5 2 ea Star handle | 10 1 ea Gun with 25 ft pressure hose |
| 2 1 ea Handle | 6 1 ea Clip | 11 1 ea Garden Hose Connector assy
(Quick coupler male + Female
garden Hose Connector) |
| 3 2 ea Hex. head screws
(M6x30) | 7 2 ea Sheet metal screw | 12 1 ea Holding clip for spray wand |
| 4 2 ea Washer | 8 1 ea Bracket | |
| | 9 1 ea Spray Wand | |

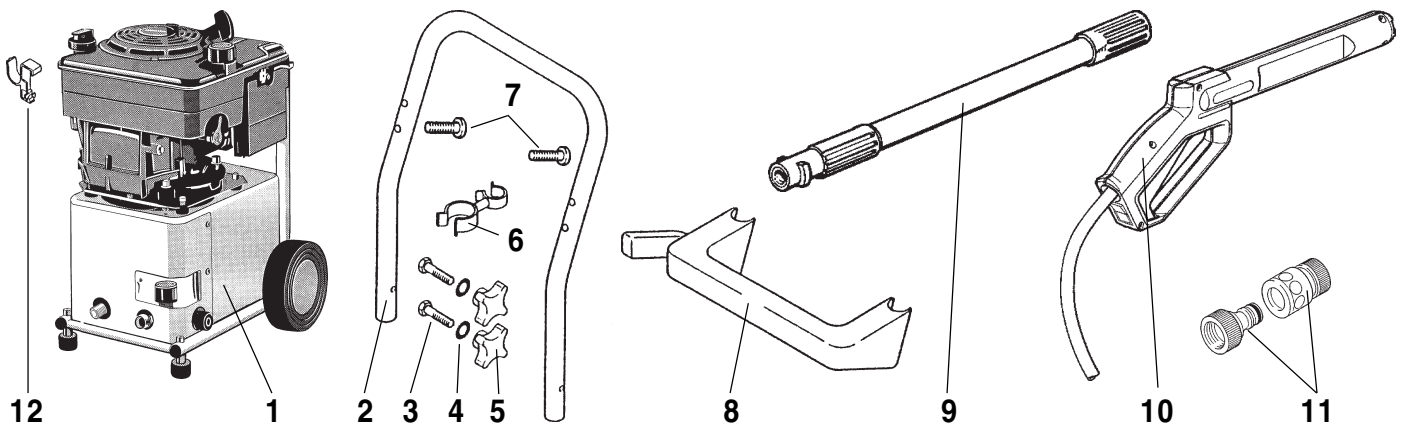

ASSEMBLY

Before using the unit, please note the following point:

Once unit has been removed from carton inspect it carefully for damages.

Should you discover any damages please notify your local SEARS RETAIL STORE.

TOOLS REQUIRED

- Screw driver

TO REMOVE FROM CARTON

- Remove spray gun and manual from carton.
- Remove all loose parts from carton.
- Cut down two corners of carton and lay end panel flat.
- Remove any packing materials.
- Roll washer out of carton.

HOW TO SET UP YOUR WASHER

(See figure on page 7)

To attach handle

- Mount handle to frame and fasten securely using the two hex. head screws with star handle and washers.
- Install bracket to handle using a screw driver and the two sheet metal screws.
- Attach wand holding clip to engine.
- Attach the clip for the detergent suction hose to the left handle.

To attach spray gun

- Push the spray wand into the trigger gun against the spring tension and turn it as far as the stop. The spray wand must lock into position.
- Screw the high-pressure hose to the high-pressure outlet.

CHECKLIST

- Before starting check the crankcase oil level.
- Check the inside of the tank for any objects or materials that could damage the pump and remove them.

ATTACHING TO WATER SUPPLY

- The flow rate of the water supply must not fall below 3 GPM and the temperature must not exceed 140 °F.
- Screw quick coupler male to the water inlet.
- Screw female garden hose connector to your garden hose. – The garden hose (*not supplied*) must be at least 1/2 inch inside diameter. –
- Now connect the garden hose with the quick coupling to the water inlet.
- Screw the other end to the water faucet.

IMPORTANT:

When connecting the water inlet to the water supply mains, local regulations of your water company must be observed. In some areas the unit must not be connected directly to the public drinking water supply. This is to ensure that there is no feedback of detergents into the water supply.

Direct connection via receiver tank or backflow preventer for example, is permitted.

The washer is not designed for suction of liquids containing such solvents as gasoline, paint thinners, oil, acids, etc.

Water can also be drawn from a standing water supply such as a lake or a drum by means of suction.

- When drawing water from a lake or drum, you must use a suction hose with filter (*not supplied*).
- Remove the garden hose connector as this is not used for suction operation.
- Connect the suction hose to the water inlet connection.
- Suspend the filter in the water tank.
- Set engine control lever to "SLOW" position, until water emerges from the nozzle.

IMPORTANT:

FOR NON PRESSURE WATER SOURCES Do not exceed 36" elevation between pressure washer and water supply and always use an inlet filter or pump damage will occur.

OPERATION

KNOW YOUR HIGH PRESSURE WASHER

READ THIS OWNER'S MANUAL AND SAFETY RULES BEFORE OPERATING YOUR HIGH PRESSURE WASHER.

Compare the illustration with your High Pressure Washer to familiarize yourself with the locations of various controls. **Save this manual for future reference.**

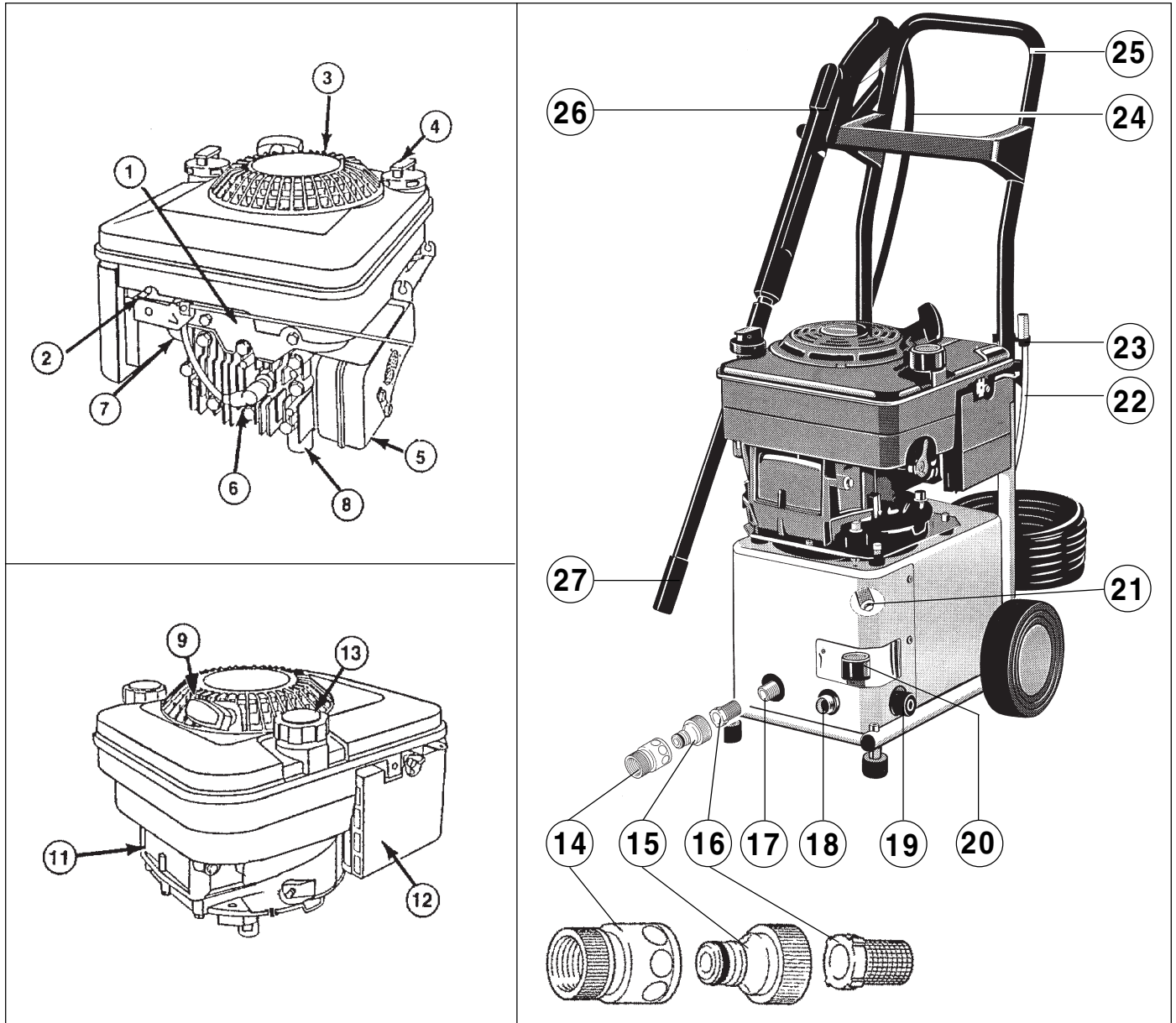

- 1 Model, type & serial numbers
- 2 Governor control lever
- 3 Static guard
- 4 Oil fill with oil dipstick
- 5 Muffler
- 6 Spark plug
- 7 Carburetor
- 8 Crankshaft
- 9 Starter grip

- 11 Cylinder
- 12 Air Cleaner
- 13 Fuel fill
- 14 Female garden hose connector
- 15 Quick coupler male
- 16 Internal strainer
- 17 Water inlet connection
- 18 High-pressure outlet
- 19 Pressure and flow regulation

- 20 Detergent metering valve
- 21 Oil drain plug
- 22 Detergent line with filter
- 23 Detergent line holder clip
- 24 High-pressure hose
- 25 Handle
- 26 Trigger Gun
- 27 Spray wand with changeover nozzle

OPERATION

BEFORE STARTING ENGINE

FUEL

- Fill fuel tank with clean, fresh, unleaded gasoline.
- Do not overfill tank. Allow approximately 1/4 in. of tank space for fuel expansion.
- Do not mix oil with gasoline.

WARNING:

Experience indicates that alcohol blended fuels (called gasohol or using ethanol or methanol) can attract moisture which leads to separation and formation of acids during storage. Acidic gas can damage the fuel system of an engine while storage. To avoid engine problems, the fuel system should be emptied before storage for 30 days or longer. Drain the fuel tank, start the engine and let it run until the fuel lines and carburetor are empty. Use fresh gasoline next season. See STORAGE Instructions for additional information. Never use engine carburetor cleaner products in the fuel tank or permanent damage may occur.

OIL

Only use high quality detergent oil rated with API service classification SF or SG. Select the oil's SAE viscosity grade according to your expected operating temperature:

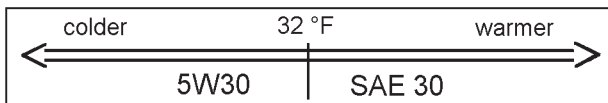

Note: Although multi-viscosity oils (5W30, 10W30 etc.) improve starting in cold weather, these multi-viscosity oils will result in increased oil consumption when used above 32 °F. Check your engine oil level more frequently to avoid possible engine damage from running low on oil.

- Be sure that engine is level.
- Remove oil dipstick.
- Fill with recommended oil, to "FULL" mark on dipstick.
- Pour slowly and do not overfill. (Capacity is approximately 1.25 pints of oil.)
- Replace oil dipstick and tighten securely.
- Check oil before each use. Add if needed.

TO START ENGINE

MEANING OF THE SYMBOLS

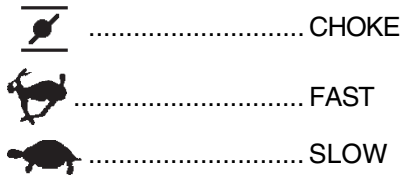

- Move engine control lever to "CHOKE" position.

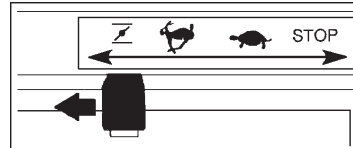

- Grasp starter grip as illustrated and pull slowly until resistance is felt.

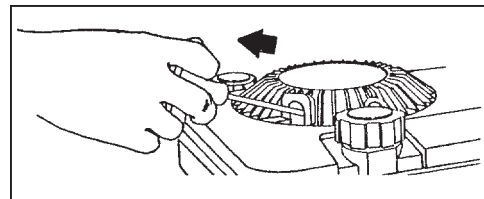

- Then pull cord rapidly to overcome compression. Do not allow starter rope to snap back.
- Repeat if necessary with engine control lever in "FAST" position.
- When engine starts, move engine control off choke position to desired speed.

TIPS

To obtain best starting performance:

- Start, store and fuel engine in a level position.
- DO NOT use pressurized starting fluids as severe internal engine damage may occur due to loss of lubrication.
- Restart a warm engine with engine control lever in "FAST" position.
- To improve cool weather starting (40 °F), see SERVICE AND ADJUSTMENTS section (page 14).

OPERATION

HOW TO USE YOUR WASHER

Pressure washer are a helpful tool designed to clean almost any type of surface in two easy steps.

- First, the application of an appropriate detergent/ solvent solution to penetrate and loosen the grime. The detergent is applied at low pressure to avoid splashing, overspray and waste. The solution is left on for 3-5 minutes to allow it to work.
- Second, the prepared surface is pressure washed and rinsed clean.

TURNING WASHER ON

IMPORTANT:

You must never run this power washer unless it is properly connected to a water supply or permanent damage may result.

- Connect to water supply and turn on water.
- Accuate gun trigger and purge lines of air.
- With gun off, start engine. (Following instructions on page 8).

When you release the gun's trigger during operation, the bypass valve opens, the water is returned to the suction side of the pump and is recirculated.

IMPORTANT:

Turn washer off if not cleaning for 10-15 minutes to prevent damage.

TURNING WASHER OFF

- To stop the engine, move control knob to "SLOW", then "STOP" position.

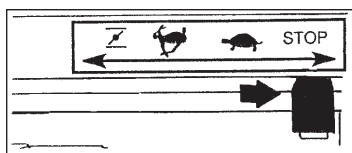

- Disconnect water supply.
- Squeeze trigger of gun until no further water emerges.
- Lock gun trigger for storage.

IMPORTANT:

Do not choke carburetor to stop the engine.

- Restart will be difficult if choke is used to stop engine.
- Fire may result if choke is used to stop engine.

DETERGENT APPLICATION

- Mix detergent solution in accordance with usage instructions.
- PH value of the solution must be between 4 and 12.
- The detergent intake can be adjusted by turning the detergent metering valve.

Valve setting	1	2	3	4
Detergent in jet (%)	1.7	3.1	4.3	5.9

Note: Valve settings "3" and "4" should only be used when there is very heavy soil.

- Place the end of detergent siphoning tube in detergent solution.
- Hook up water supply.
- Twist nozzle (see Fig. page 10) to select low pressure operation.

Note: Machine is designed to only apply detergents at low pressure through chemical injection siphoning tube.

- Start washer and apply detergent on dry surface, starting from the bottom and working up.

Note: Detergents are most effective when applied to a dry surface.

- Cover only enough surface so that it does not dry before washing / rinsing.



DO NOT USE:

- BLEACH AND OTHER CORROSIVE CHEMICALS
- LIQUIDS CONTAINING SOLVENTS (IE. PAINT THINNERS, GASOLINE, OIL)
- CHLORINE PRODUCTS
- TRI-SODIUM PHOSPHATE PRODUCTS
- AMMONIA PRODUCTS
- ACID-BASED PRODUCTS

OPERATION

PRESSURE WASH / RINSE

- Hook up water supply.
- Twist nozzle to select high pressure operation.
Note: Detergent solution will not flow when in the high pressure mode.
- Start washer and work from the top of the surface down.
- The pressure washer is most effective when the tip of the wand is held 6 to 24 inches from the surface being cleaned.

FLOW REGULATION

- The water flow and pressure can be easily adjusted by turning the control knob.
- Pressure can be read on end of kontrol knob. Higher pressure is recommended for most jobs.
- Turning clockwise:
less water and lower pressure
- Turning counterclockwise:
more water and higher pressure

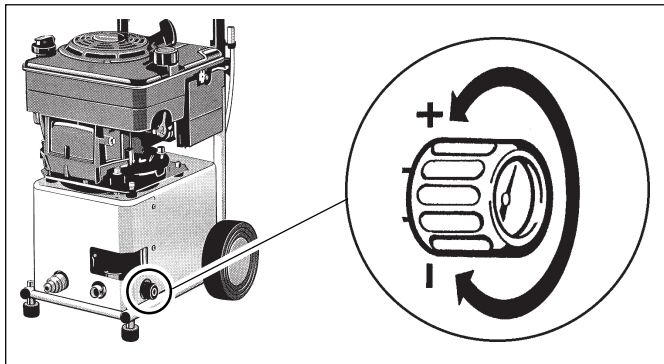

CHANGEOVER NOZZLE

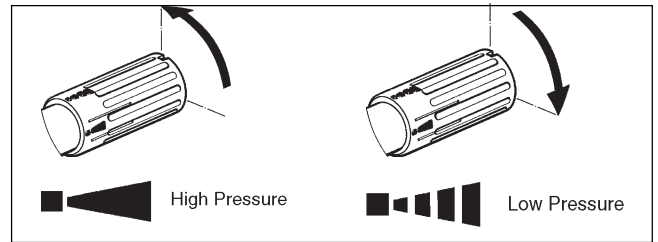

- It is possible to work with a high pressure or a low pressure jet. The symbol of the chosen jet form is on the upper side of the changeover nozzle.
- Changing the jet form is only possible with the trigger gun closed.
 - Release trigger.
 - Turn changeover nozzle 90° to alter pressure of the water jet.

Note: Detergents can only be syphoned at low pressure.

CLEANING TIPS

- For best results, the high-pressure lance should be held between 6"-24" away from the surface being cleaned. Holding the wand too close to the surface may damage the object being cleaned. On the other hand, if the lance is too far away, optimum cleaning results will not be achieved. It's always best to test the surface first to see if damage occurs when the lance is held too close.
- When cleaning car tires, the nozzle should be held at least 6" from the surface to avoid damage.
- Apply detergent at low pressure from the bottom up and pressure wash at high pressure from the top down.
- Always apply detergent to a dry surface and allow 1-3 minutes dwell time.
- To be environmentally safe,
 - cleaning engines is only recommended where a suitable oil separator is provided.
 - clean facades, terraces and garden equipment with the high-pressure jet alone, without cleaning agent.

Note: With special accessories (not included) it can also be used for such jobs as removing rust and paint, for cleaning pipes, for pumping water and for applying plant protection chemicals. These items are available from most SEARS RETAIL OUTLETS.

CUSTOMER RESPONSIBILITIES

GENERAL RECOMMENDATIONS

The warranty on this pressure washer does not cover items that have been subjected to operator abuse or negligence. To receive full value from the warranty, the operator must maintain the pressure washer as instructed in this manual.

Some adjustments will have to be made periodically to properly maintain this unit.

- Once a year change the spark plug and clean the air filter element.
- Follow the recommended maintenance schedule and make in-between checks. This will help you obtain maximum engine life.

BEFORE EACH USE

- Clean water inlet filter. (→A)
- Check the oil level of the engine. (→B)
- Check for any loose fasteners.

AFTER EACH USE

- Flush detergent siphoning tube with fresh water.
- Disconnect water inlet hose and inspect / clean the inlet filter.
- Clean nozzle assembly.
- Wipe hose, cord assembly unit to remove dirt, oil etc.

MAINTENANCE SCHEDULE

Follow the hourly or calendar intervals, **whichever occur first.**

Maintenance Operation		Every 8 Hours or Daily	25 Hours or Every Season	50 Hours or Every Season	100 Hours or Every Season
A.	Clean Water Inlet Filter				
B.	Check Motor Oil Level				
C.	Clean Static Guard				
D.	Clean Engine				
E.	Service Air Cleaner	2			
F.	Inspect Spark Arrester (Optional Accessory)				
G.	Change Motor Oil	1			
H.	Clean Cooling System	2			
I.	Replace or Clean Spark Plug				
K.	Cleaning Nozzle Assembly				

1 Change oil after first 5 hours, then after every 50 hours or every season.

2 Clean more often under dusty conditions or when airborne debris is present



To prevent accidental starting when servicing the unit, always remove the spark plug or wire from the spark plug, and shut off the water supply.

CUSTOMER RESPONSIBILITIES

A. CLEANING WATER INLET FILTER

The water inlet to the washer is protected by a filter which should be cleaned if it is found to be dirty.

- Disconnect water inlet hose.
- Pull out internal filter.
- Clean filter.
- Reinstall filter.

B. CHECK MOTOR OIL LEVEL

Be sure oil level is maintained.

- Remove oil dipstick and wipe oil from dipstick with clean cloth.
- Screw dipstick firmly into place until cap bottoms on tube.
- Remove to check oil level.
Dipstick assembly must be firmly assembled into tube when engine is operating.

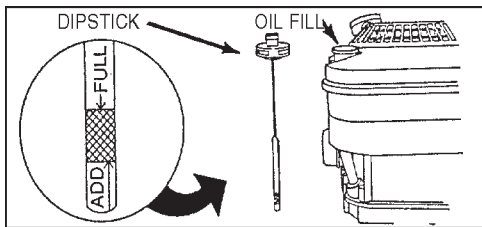

C. CLEAN STATIC GUARD

- Clean the area shown to prevent overheating and engine damage.

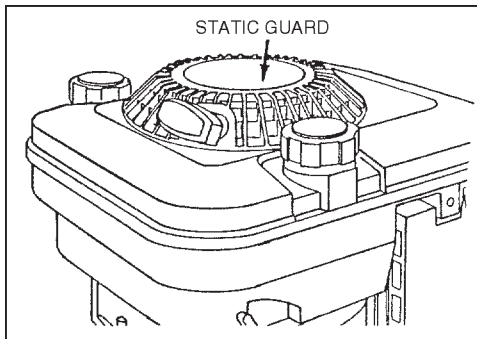

Caution: To assure smooth operation, keep governor linkage, springs and controls free of debris.

D. CLEAN ENGINE

Remove dirt and debris with a cloth or brush. Cleaning with a forceful spray of water is not recommended as water could contaminate the fuel system.

E. SERVICE AIR CLEANER

1. Loosen screw and tilt cover as illustrated.
2. Carefully remove cartridge.
3. Clean by tapping gently on a flat surface. If very dirty, replace cartridge or clean as follows:

Wash in a low or non-sudsing detergent and warm water solution. Rinse thoroughly with flowing water from mesh side until water runs clear. Let cartridge air dry thoroughly before using.

Caution: Petroleum solvents, such as kerosene, are not to be used to clean cartridge. They may cause deterioration of the cartridge. Do not oil cartridge. Do not use pressurized air to clean or dry cartridge.

4. Install cartridge, then close cover and fasten screw securely.

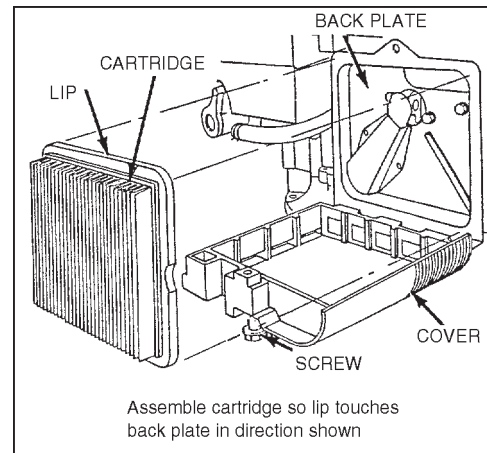

F. CLEAN SPARK ARRESTER (OPTIONAL)

If engine is equipped with spark arrester screen assembly, remove for cleaning and inspection. Replace if damaged.

CUSTOMER RESPONSIBILITIES

G. CHANGE MOTOR OIL

Oil recommendations see page 8.

- Change oil while engine is warm.
- To drain oil completely, always place engine level.
- Open screws and remove front cover.
- Open oil drain plug.
- Drain oil completely through the oil drain plug.
- Replace oil drain plug.
- Replace front cover.
- Remove oil dipstick.
- Clean area around the oil fill.
- Pour oil slowly in oil fill.
(Refill with new oil of proper grade.)
- Fill to "FULL" mark on dipstick.
- **DO NOT overfill.**
(Capacity is approximately 1.25 pints.)
- Replace dipstick.

Caution: When tipping to service engine or equipment keep engine spark plug or air cleaner side up.

H. CLEAN COOLING SYSTEM

Dirt may clog the engine's air cooling system. The cooling fins and surfaces may require cleaning to prevent overspeeding, overheating and engine damage.

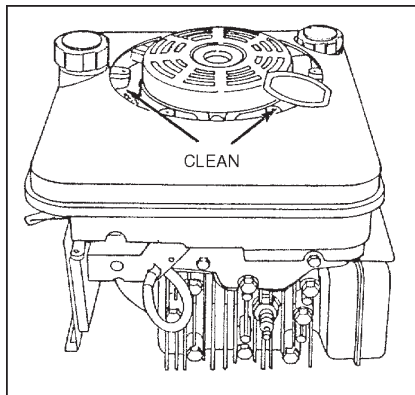

I. REPLACE SPARK PLUG

- Replace spark plug if electrodes are pitted, burned or if porcelain is cracked.
- Use a "CHAMPION" spark plug or equivalent.

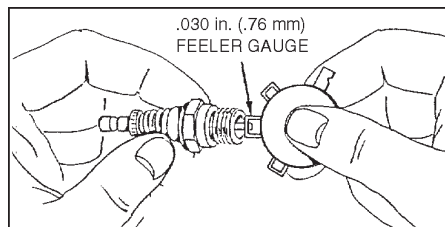

Note: Do not blast clean spark plug. Spark plug should be cleaned by scraping or wire brushing and washing with a commercial solvent.

Important:

Sparking can occur if wire terminal does not fit firmly on spark plug. Reform terminal if necessary.

K. CLEANING NOZZLE ASSEMBLY

- Disconnect the spray wand from the trigger gun.
- Remove dirt from nozzle bore with needle and rinse with water from nozzle end.
- Reinstall

SERVICE AND ADJUSTMENTS

PRESSURE

See OPERATION SECTION.

DETERGENT FLOW

See OPERATION SECTION.

PUMP

The pump is sealed and does not require any lubrication.

HIGH-PRESSURE HOSE

- Replace leaking fittings and hose.
- Do not attempt to repair, as they are designed to carry high pressure.



It is extremely dangerous to use high-pressure hoses of low durability or that have been inexpertly repaired and so you should only use original high-pressure hoses that have been tested and marked.

REPAIR PARTS

If only original spare parts are used, you can be sure that your unit will also work safely and without trouble in the future.

For replacement parts information and ordering call 1-800-366-7278.



The use of other than original spare parts could lead to faults and even to serious accidents if such parts are not properly manufactured or if they do not exactly replace the original part.

ENGINE SPEED

The engine speed is factory set. Do not attempt to increase speed as it may result in damage to washer or personal injury. If you believe your engine is running too slow or too fast, take your washer to an authorized Sears Service Center.

CARBURETOR ADJUSTMENTS

If engine does not accelerate properly (cool weather starting), the carburetor should be adjusted to a slightly richer mixture.

- Turn idle mixture screw 1/8 turn counterclockwise.
Note: Do not forget to adjust back.

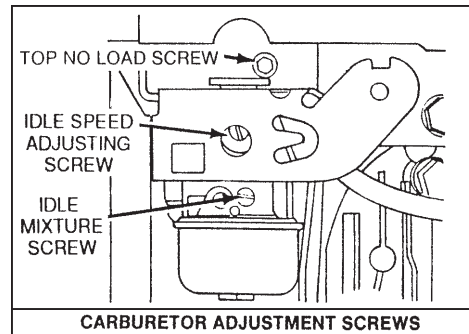

Do not adjust "TOP NO LOAD SCREW" and "IDLE SPEED ADJUSTING SCREW" they are pre-set at Factory.



NO ADJUSTMENTS SHOULD BE MADE TO ANY PARTS THAT ARE SEALED.

STORAGE

Immediately prepare your Power Washer for storage if the unit will not be used for 30 days or more.

ENGINE

FUEL SYSTEM

Remove all gasoline from carburetor, fuel filter and fuel tank to prevent gum deposits forming on these parts.

IMPORTANT:

It is important to prevent gum deposits from forming in essential fuel system parts such as carburetor, fuel filter, fuel hose or tank during storage. Also experience indicates that alcohol blended fuels (called gasohol or using Ethanol or Methanol) can attract moisture which leads to separation and formation of acids during storage. Acidic gas can damage the fuel system of an engine while in storage.

- Drain the fuel tank.
- Run engine until it stops from lack of fuel.
- Use fresh fuel next season.

Note:

Fuel stabilizer (Sears Fuel Stabilizer No. 33500) is an acceptable alternative in minimizing the formation of fuel gum deposits during storage.

Add stabilizer to gasoline in fuel tank or storage container. Always follow the mix ratio found on stabilizer container. Run engine at least 10 minutes after adding stabilizer to allow the stabilizer to reach the carburetor. Do not drain the fuel tank and carburetor if using fuel stabilizer.

ENGINE OIL

- Drain oil (with engine warm) and replace with clean engine oil. (See "G. Change Motor Oil" in the Customer Responsibilities section of this manual).

CYLINDER

- Remove spark plug.
- Pour approximately 1/2 ounce (15 ml) of engine oil through spark plug hole into the cylinder.
- Pull starter handle slowly a few times to distribute oil.
- Replace spark plug.

PUMP

The pump will be severely damaged if it is stored in a location where the temperature falls below freezing point without its first being emptied of water or flushed through with 50 % Anti-freeze solution.

The best protection against freezing is to store the Power Washer and the accessories (high-pressure hose, trigger gun, spray lance) in a room where the temperature will not fall to the freezing point.

To empty the pump

- Disconnect the Power Washer from the water supply.
- Disconnect the HP hose from the cleaner.
- The water will drain out.

Flushing with Anti-freeze solution

If the cleaner is to be out of operation for any length of time, it is advisable to flush it through with a glycol solution as this provides a certain degree of protection against corrosion. A solution of 50 % Anti-freeze, 50 % water is pumped through the cleaner.

Note: *A cleaner that may have frozen up should first be thawed before it is put back into use as otherwise damage may be caused.*

OTHER

- Clean dirt and carbon from cylinder, cylinder head fins, blower housing and muffler areas.
- Do not store gasoline from one season to another.
- Replace your gasoline can if your can starts to rust. Rust and/or dirt in your gasoline will cause problems.
- Store in a clean and dry area.
- If possible, store your unit indoors and cover it to give protection from dust and dirt.

Note: *Cover your unit with a suitable protective cover that does not retain moisture. Do not use plastic. Plastic cannot breathe which allows condensation to form and will cause your unit to rust.*



Never store the Power Washer with gasoline in the tank inside a building where fumes may reach an open flame or spark. Allow the engine to cool before storing in any enclosure.

TROUBLESHOOTING POINTS

Fault	Cause	Remedy
Engine will not start	<ul style="list-style-type: none"> - Fuel tank empty - Dirty air filter - Stale fuel - Water in fuel - Spark plug wire disconnected - Bad spark plug 	Fill fuel tank Clean/replace air filter Drain tank and refill tank with fresh, clean fuel Drain tank and refill tank with fresh, clean fuel Connect spark plug wire Replace spark plug
Unit does not come up to pressure	<ul style="list-style-type: none"> - Pump is sucking air - Strainer is blocked - Pump not bled to remove air - Flow regulation control is set to low pressure - Pump or relief valve defective 	Open water supply and check garden hose Clean strainer Stop engine, press trigger of gun, start engine and run unit while depressing trigger Turn control knob to high pressure Have unit repaired by authorized service
Water spray irregular	<ul style="list-style-type: none"> - Nozzle clogged - Water supply inadequate - Relief valve incorrectly set 	Clean nozzle Check to see that water supply is on full force or use stationary water source. Have unit repaired by authorized service
No intake of detergent	<ul style="list-style-type: none"> - Nozzle in improper position - Detergent metering valve closed - Suction filter clogged - Nozzle clogged 	Set nozzle to low pressure position Adjust detergent metering valve to desired setting. Clean filter in suction nozzle Clean nozzle

SERVICE NOTES

SERVICE NOTES

SERVICE NOTES



OWNER'S MANUAL

MODEL NO.
559.741720

HOW TO ORDER REPAIR PARTS

CRAFTSMAN®

5 HORSEPOWER HIGH PRESSURE WASHER

Each High Pressure Washer has its own model number. Each engine has its own model number.

The model number for your High Pressure Washer will be found on a decal attached to High Pressure Washer.

The model number for the engine will be found on the engine adjacent to the spark plug.

All parts listed herein may be ordered through Sears, Roebuck and Co. Service-Centers and most Retail Stores.

WHEN ORDERING REPAIR PARTS, ALWAYS GIVE THE FOLLOWING INFORMATION:

- PRODUCT - **Pressure Washer**
- MODEL NUMBER - **559.741720**
- ENGINE MODEL NO. - **123702 (Briggs & Stratton)**
- PART NUMBER
- PART DESCRIPTION

Your Sears merchandise has added value when you consider that Sears has service units nationwide staffed with Sears trained technicians.. professional technicians specifically trained on Sears products, having the parts, tools and the equipment to insure that we meet our pledge to you, we service what we sell.